

**DEVELOPMENT ASSESSMENT**

- OVERALL SITE AREA = 375,700 sqm
- BUILDING SITE COVER = 2,025 sqm (INCLUDES ROOF AREA)
- LANDSCAPING AREA = 3,610 sqm
- ROAD & PARKING AREA = 8,605 sqm
- TOTAL SITE COVER: 3.26%

**IMPERVIOUS AREAS - BUILDINGS**

- PRE SITE DEVELOPMENT = 158 sqm (INCLUDES ROOF AREA)
- POST SITE DEVELOPMENT = 2,025 sqm (INCLUDES ROOF AREA)

**BUILDING AREAS - GFA**

- OPEN SHED = 158 sqm
- COFFEE SHOP = 158 sqm
- AMENITIES BLOCKS = 120 sqm
- COFFEE VAN = 82 sqm
- GARDEN CENTRE = 1,327 sqm
- CABINS (TOTAL) = 200 sqm
- MARKET AREA = 1691 sqm



**RECEIVED**  
19/05/2026  
**TOOWOOMBA REGIONAL COUNCIL**

- Stage 1
- Stage 2
- Stage 3

**Legend**

- Gravel track
- Subject boundary
- Adjoining boundary
- Garden/Tree Line
- Fence

Note:  
This plan was prepared for TAYLOR MADE ENGINEERING to accompany a Material Change of Use application to the TOOWOOMBA REGIONAL Council and should not be used for any other purpose. This note is an integral part of this plan



SCALE 1: 2000

**TAYLOR MADE ENGINEERING**  
**SMK QLD**  
Goondiwindi · Brisbane · Gold Coast · Toowoomba · Gatton  
Phone: (07) 4671 2445 Email: admin@smkqld.com.au

Proposal location of Coffee Shop to  
Accompany MCU Application  
Lot 29 on RP825872

24082 A3 24082-2  
SCALE Horiz 1:2000 Ver 1:100

DRAWN BY MLH 15/5/2026 3:02PM C:\Users\SMK\Dropbox\JOBS\2024\24082 TAYLOR MADE ENGINEERING\Working Documents\24082-1.pro

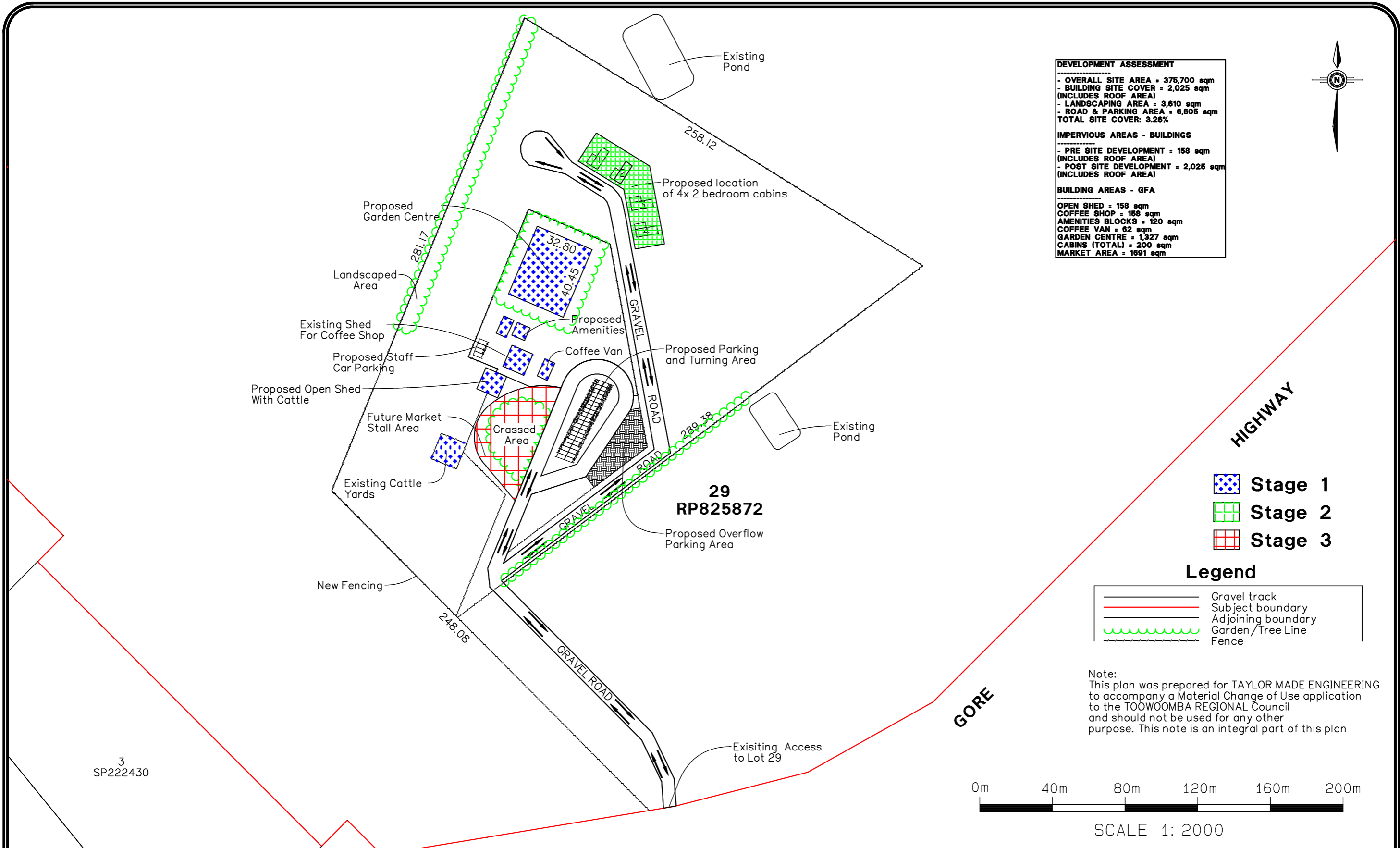

**TAYLOR MADE ENGINEERING**  
**SMK QLD**

Goondiwindi · Brisbane · Gold Coast · Toowoomba · Gatton  
Phone: (07) 4671 2445 Email: admin@smkqld.com.au

Proposal location of Coffee Shop to  
Accompany MCU Application  
Lot 29 on RP825872

24082

A3

24082-3

SCALE Horiz 1:2000  
Ver 1:100

DRAWN BY MLH

15/5/2026  
3:04PM

C:\Users\SMK\Dropbox\JOB5\2024\24082 TAYLOR MADE ENGINEERING\Working Documents\24082-1.pro