

DRAWING LIST:

- PLN_118273-G-001 - LOCALITY PLAN

EARTHWORKS DRAWINGS:

- PLN_118273-E-001 - LEVELS AND GRADING LAYOUT
- PLN_118273-E-002 - EARTHWORKS SECTIONS LAYOUT SHEET 1 OF 3
- PLN_118273-E-003 - EARTHWORKS SECTIONS LAYOUT SHEET 2 OF 3
- PLN_118273-E-004 - EARTHWORKS SECTIONS LAYOUT SHEET 3 OF 3
- PLN_118273-E-005 - BULK EARTHWORKS LAYOUT
- PLN_118273-E-006 - SOIL AND SEDIMENTATION PLAN
- PLN_118273-E-007 - PAVEMENT AND CONCRETE JOINTING PLAN

DRAINAGE DRAWINGS:

- PLN_118273-D-001 - DRAINAGE LAYOUT

SWEPT PATH DRAWINGS:

- PLN_118273-SP-001- SWEPT PATH LAYOUT

LOT 4 ENDEAVOR WAY, TORRINGTON

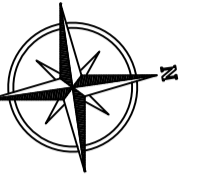

ENDEAVOUR WAY

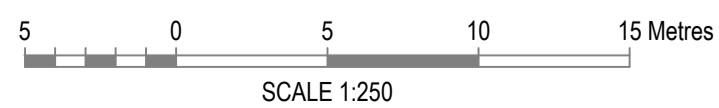
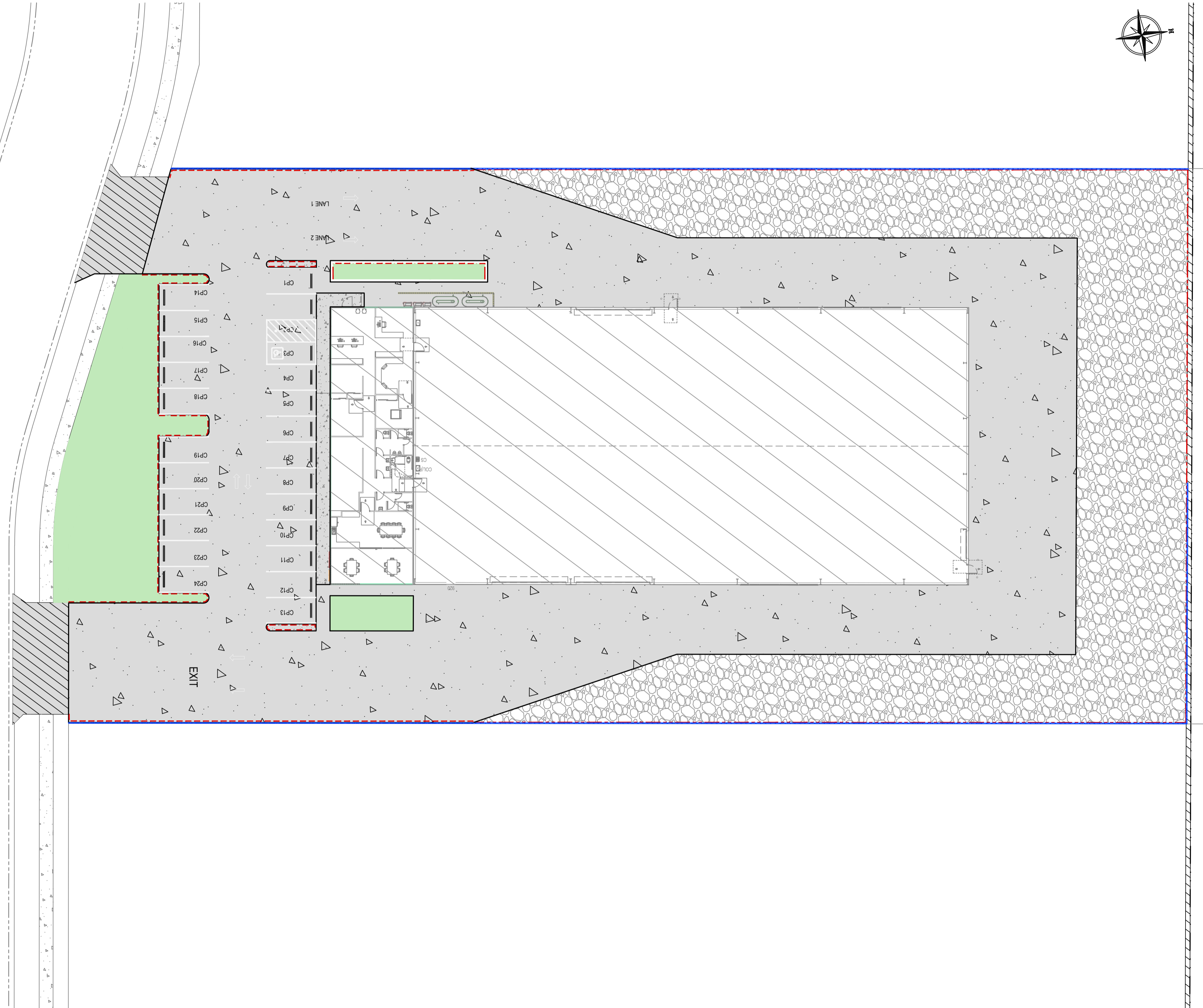

WARNING
BEWARE OF UNDERGROUND SERVICES
THE LOCATION OF UNDERGROUND CABLES ARE APPROXIMATE ONLY AND THEIR EXACT POSITION SHOULD BE CHECKED ON SITE. NO GUARANTEE IS GIVEN THAT ALL EXISTING CABLES AND SERVICES ARE SHOWN. LOCATE ALL UNDERGROUND CABLES AND SERVICES BEFORE COMMENCEMENT OF WORK. REFER TO WORKSAFE REGULATION 3.21.

REV.	BY	DATE	DESCRIPTION
A	ZS/RS	2026.04.09	FOR APPROVAL

Copyright VPE CONSULTING PLY LTD. T: +61 8 6400 7433 | Email: admin@vpeconsulting.com.au



TITLE	GENERAL LAYOUT	DATE	2026.04.09	REV	A
DRAWN	ZINALDU SWART	DESIGNED	RIANDOR SWART	CHECKED	ROBERT SMITH
PROJECT	LOT 4 ENDEAVOUR WAY, TORRINGTON	A1 SCALE	AS NOTED ON DRAWING	JOB REF.	PLN_118273
DWG No.	PLN_118273-G-001				

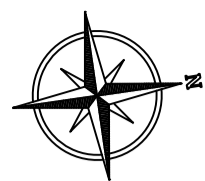

LEGEND	
(EXISTING)	
CADASTRAL BOUNDARY	
ROAD	
SEWER	
WATER	
NATURAL CONTOURS 0.2 INTERVALS	
DRAINAGE	
SEWER MH	
DRAINAGE MH	
SIDE ENTRY PIT	
RETAINING WALL BY OTHER	
FOOTPATH	
(PROPOSED)	
DESIGN CONTOURS 0.1m INTERVALS	
EDGE OF SEAL	
RETAINING WALL	
(REFER TO IMPACT STRUCTURAL ENGINEERS FOR DETAIL)	
200mm WIDE ACO S200K SLOPED CHANNEL	
STRIP DRAIN WITH CLASS D GRATE	
(REFER TO GENERAL NOTE 7)	
0.1m HIGH IN-SITU CONCRETE "BK"	
(REFER TO GENERAL NOTE 6)	
0.15m HIGH IN-SITU CONCRETE "BK1"	
(REFER TO GENERAL NOTE 6)	
BARRIER KERB TYPE 7 "BK7"	
(REFER TO GENERAL NOTE 6)	
BARRIER KERB TYPE 24 "BK24"	
(REFER TO GENERAL NOTE 6)	
PAVEMENT DRAIN	
(ARROW INDICATES DIRECTION OF FLOW)	
PAVEMENT DRAIN	
(ARROW INDICATES DIRECTION OF FLOW)	
DRAINAGE PIPE	
(REFER TO GENERAL NOTE 8)	
(ARROW INDICATED DIRECTION OF FLOW)	
RKO GRATED DRAINAGE PITS	
(REFER TO GENERAL NOTE 8)	
LANDSCAPING	
CROSSOVER TO BE CONSTRUCTED IN ACCORDANCE TO DRAWING RSD-102	
BUILDING	
CONCRETE	
(REFER TO NOTE 6)	
GRAVEL AREA	
(REFER TO NOTE 9)	
FOOTPATH	
WHEELSTOPS TO AS 2890.1	
KERB TRANSITION TRANSITION KERB FROM 0 HEIGHT TO 100mm HIGH	

- GENERAL NOTES**
1. ALL DIMENSIONS IN METRES U.N.O
 2. ALL DRAWINGS SHALL BE READ IN CONJUNCTION WITH SPECIFICATION.
 3. CONTRACTORS TO UNDERTAKE A DILAPIDATION SURVEY OF ALL BUILDING WITHIN 30m OF THE SITE'S BOUNDARIES PRIOR TO COMMENCEMENT OF CONSTRUCTION.
 4. CONTRACTOR TO MAINTAIN ACCESS TO EXISTING LOTS AT ALL TIMES DURING CONSTRUCTION.
 5. A DUST MANAGEMENT PLAN MUST BE SUBMITTED AND APPROVED BY COUNCIL. THE CONTRACTOR MUST ADHERE TO THE APPROVED DUST MANAGEMENT PLAN.
 6. REFER TO PLN_118273-E-007 FOR PAVEMENT AND KERBING DETAILS
 7. REFER TO PLN_118273-D-001 FOR DETAILS

- SITE CLEARING:**
1. A JOINT SITE INSPECTION BY THE CONTRACTOR AND THE SUPERINTENDENT IS TO BE CARRIED OUT BEFORE COMMENCEMENT OF CLEARING.
 2. THE CONTRACTOR SHALL CLEAR VEGETATION AND DEBRIS FROM WITHIN THE SITE BOUNDARY IN ACCORDANCE WITH THE SPECIFICATION EXCEPT FOR VEGETATION SHOWN AS RETAINED.
 3. VEGETATION TO BE RETAINED SHALL BE PROTECTED IN ACCORDANCE WITH THE SPECIFICATION.
 4. ALL EXCESS MATERIAL SHALL BE DISPOSED OFFSITE/MULCHED AND STOCKPILED FOR FUTURE USE ON SITE.
 5. THE FINISHED SURFACE, INCLUDING ANY AREAS OUTSIDE OF THE SITE AREA EXPOSED BY THE CONTRACTOR DURING THE WORKS, SHALL BE STABILIZED BY APPLICATION OF SEEDED AN DYED HYDROMULCH AS SPECIFIED.

- GEOTECHNICAL VERIFICATION:**
1. THE CONTRACTOR SHALL ENGAGE A GEOTECHNICAL ENGINEER TO PERFORM THE FOLLOWING TASKS.
 - INSPECT AND PROVIDE VERIFICATION OF ADEQUATE TOPSOIL STRIPPING.
 - INSPECT AND PROVIDE VERIFICATION OF ADEQUATE PROOF ROLLING.
 - INSPECT AND PROVIDE VERIFICATION THAT EARTHWORKS HAVE BEEN PERFORMED IN ACCORDANCE WITH THE WORD AND INTENT OF THE CONTRACT DOCUMENTS UPON COMPLETION OF EARTHWORKS.
 - ALL GEOTECHNICAL VERIFICATION SHALL BE SUBMITTED TO AND APPROVED BY THE SUPERINTENDENT PRIOR TO PRACTICAL COMPLETION.

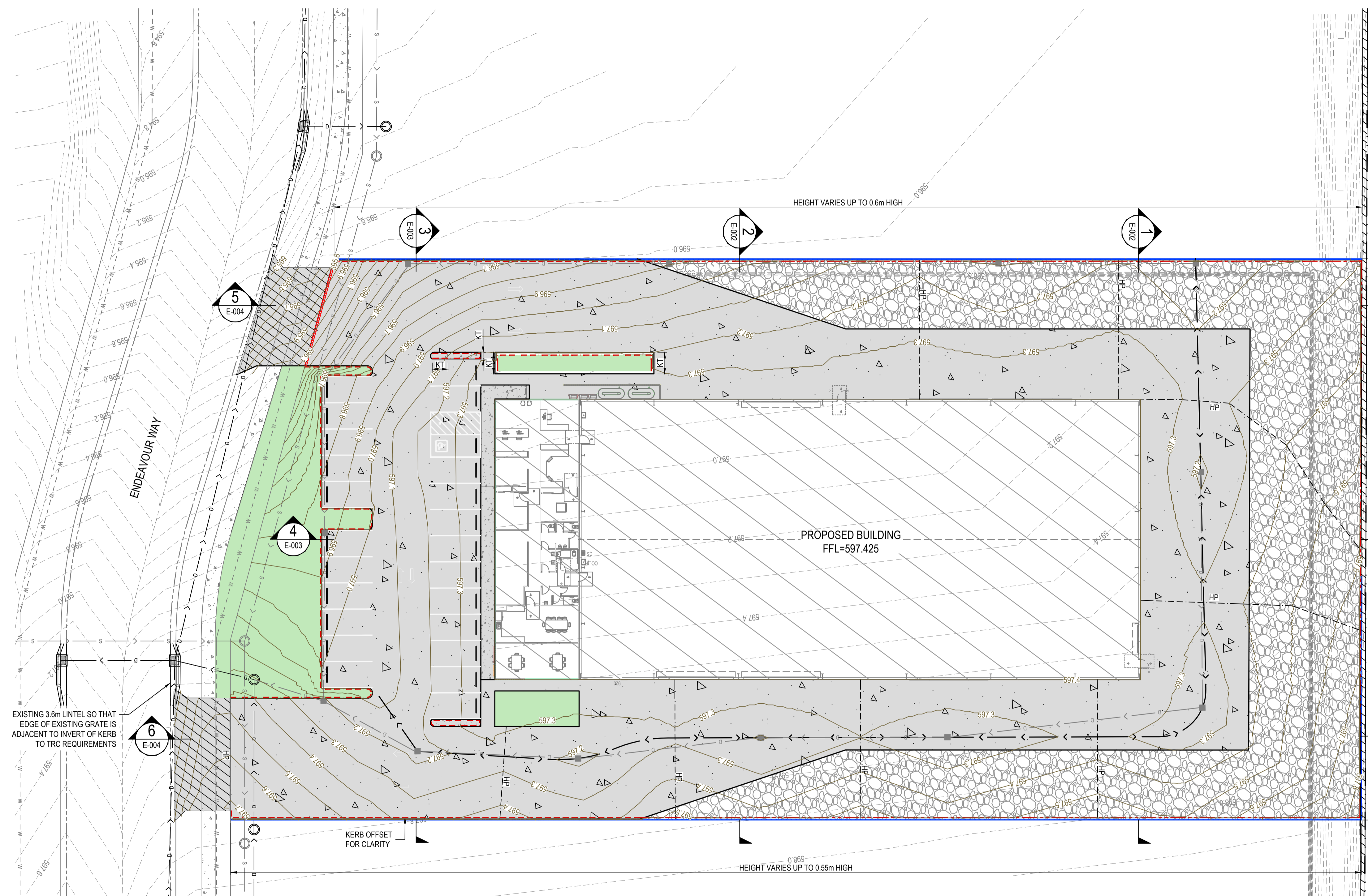

LEVELS AND GRADING LAYOUT
SCALE 1:250

EXISTING 3.6m LINTEL SO THAT EDGE OF EXISTING GRATE IS ADJACENT TO INVERT OF KERB TO TRC REQUIREMENTS

KERB OFFSET FOR CLARITY

HEIGHT VARIES UP TO 0.6m HIGH

HEIGHT VARIES UP TO 0.55m HIGH

WARNING
BEWARE OF UNDERGROUND SERVICES
THE LOCATION OF UNDERGROUND CABLES ARE APPROXIMATE ONLY AND THEIR EXACT POSITION SHOULD BE CHECKED ON SITE. NO GUARANTEE IS GIVEN THAT ALL EXISTING CABLES AND SERVICES ARE SHOWN. LOCATE ALL UNDERGROUND CABLES AND SERVICES BEFORE COMMENCEMENT OF WORK. REFER TO WORKSAFE REGULATION 3.21.

DIAL 1100
BEFORE YOU DIG

REV.	BY	DATE	DESCRIPTION
A	ZS/RS	2026.04.09	FOR APPROVAL

Copyright VPE CONSULTING PLY LTD. T: +61 8 6400 7433 | Email: admin@vpeconsulting.com.au



TITLE	DATE	REV	A
LEVELS AND GRADING LAYOUT	2026.04.09		
DRAWN	ZINALDU SWART		
DESIGNED	RIANDOR SWART		
CHECKED	ROBERT SMITH		
A1 SCALE	AS NOTED ON DRAWING		
DWG No.	PLN_118273-E-001		
JOB REF.	PLN_118273		

- LEGEND**
- HEAVY DUTY CONCRETE PAVEMENT (REFER TO NOTE 3)
 - GRAVEL PAVEMENT (REFER TO NOTE 3)

- GENERAL NOTES**
- REFER TO DRAWING PLN_118273-E-001 FOR SECTION LOCATIONS.
 - REFER TO PAVEMENT PLAN ON DRAWING PLN_118273-E-007.
 - REFER TO DRAWING PLN_118273-E-007 FOR TYPICAL PAVEMENT DETAILS.
 - RETAINING WALLS AND PERIMETER KERBS AT BOUNDARY ARE NOT SHOWN ON SECTIONS.

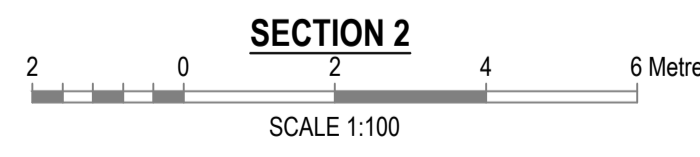
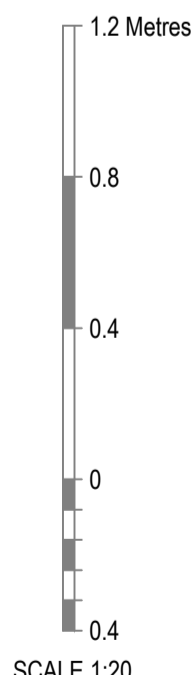
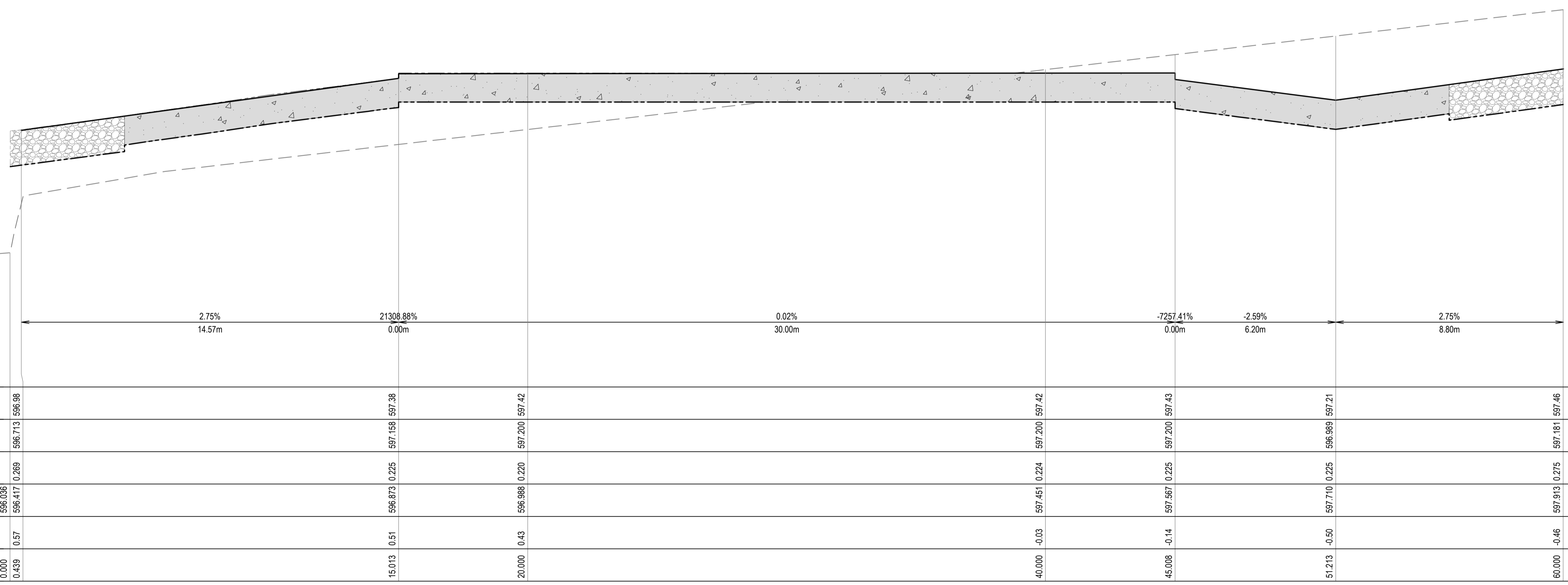
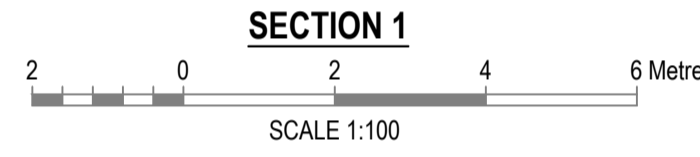
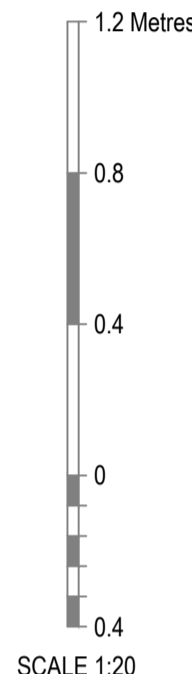
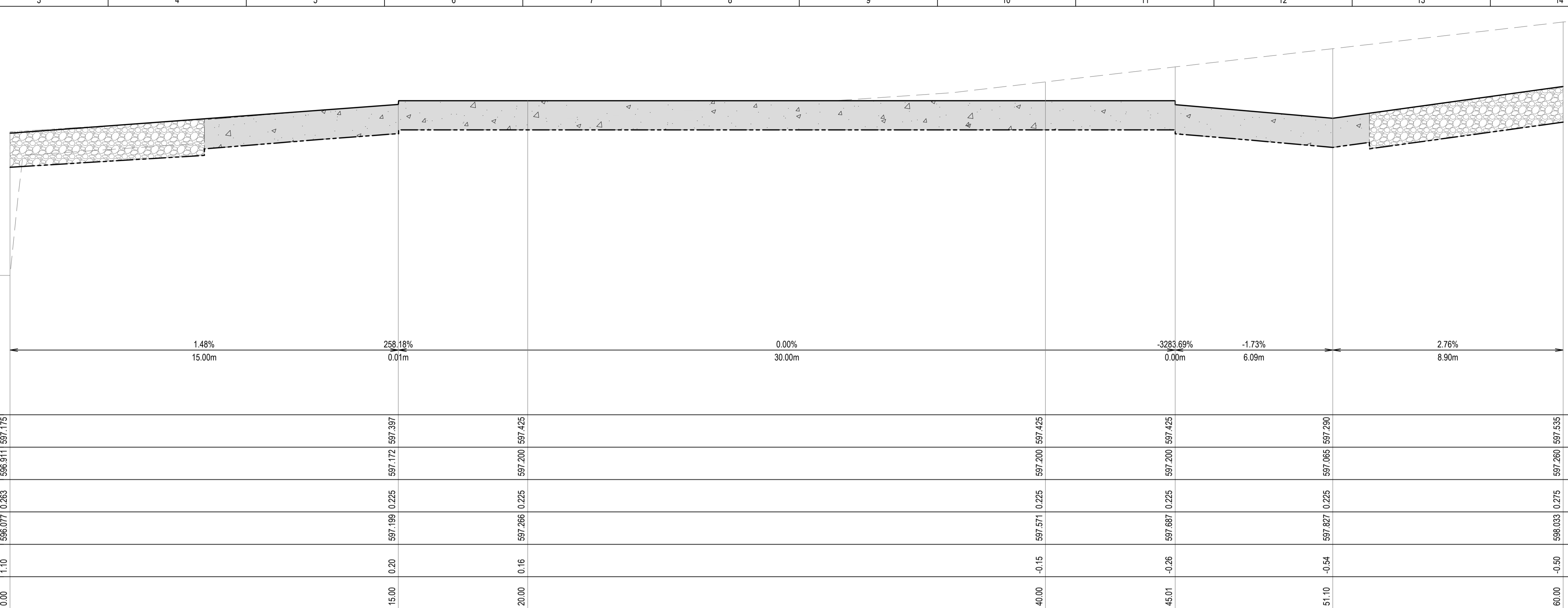

WARNING
BEWARE OF UNDERGROUND SERVICES
THE LOCATION OF UNDERGROUND CABLES ARE APPROXIMATE ONLY AND THEIR EXACT POSITION SHOULD BE CHECKED ON SITE. NO GUARANTEE IS GIVEN THAT ALL EXISTING CABLES AND SERVICES ARE SHOWN. LOCATE ALL UNDERGROUND CABLES AND SERVICES BEFORE COMMENCEMENT OF WORK. REFER TO WORKSAFE REGULATION 3.21.

DIAL 1100
BEFORE YOU DIG

REV.	BY	DATE	DESCRIPTION
A	ZS/RS	2026.04.09	FOR APPROVAL

Copyright VPE CONSULTING PLY LTD. T: +61 8 6400 7433 | Email: admin@vpeconsulting.com.au



TITLE	EARTHWORKS SECTIONS LAYOUT SHEET 1 OF 3
PROJECT	LOT 4 ENDEAVOR WAY, TORRINGTON
DWG No.	PLN_118273-E-002

DATE	2026.04.09	REV	A
DRAWN	ZINALDU SWART		
DESIGNED	RIANDOR SWART		
CHECKED	ROBERT SMITH		
A1 SCALE	AS NOTED ON DRAWING		
JOB REF.	PLN_118273		

LEGEND
 HEAVY DUTY CONCRETE PAVEMENT
 (REFER TO NOTE 3)
 LIGHT DUTY CONCRETE PAVEMENT
 (REFER TO NOTE 3)
 GRAVEL PAVEMENT
 (REFER TO NOTE 3)

GENERAL NOTES
 1. REFER TO DRAWING PLN. 118273-E-001 FOR SECTION LOCATIONS.
 2. REFER TO PAVEMENT PLAN ON DRAWING PLN. 118273-E-007.
 3. REFER TO DRAWING PLN. 118273-E-007 FOR TYPICAL PAVEMENT DETAILS.
 4. RETAINING WALLS AND PERIMETER KERBS AT BOUNDARY ARE NOT SHOWN ON SECTIONS.

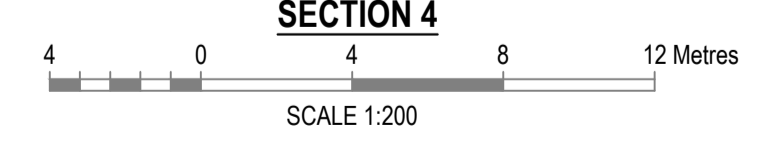
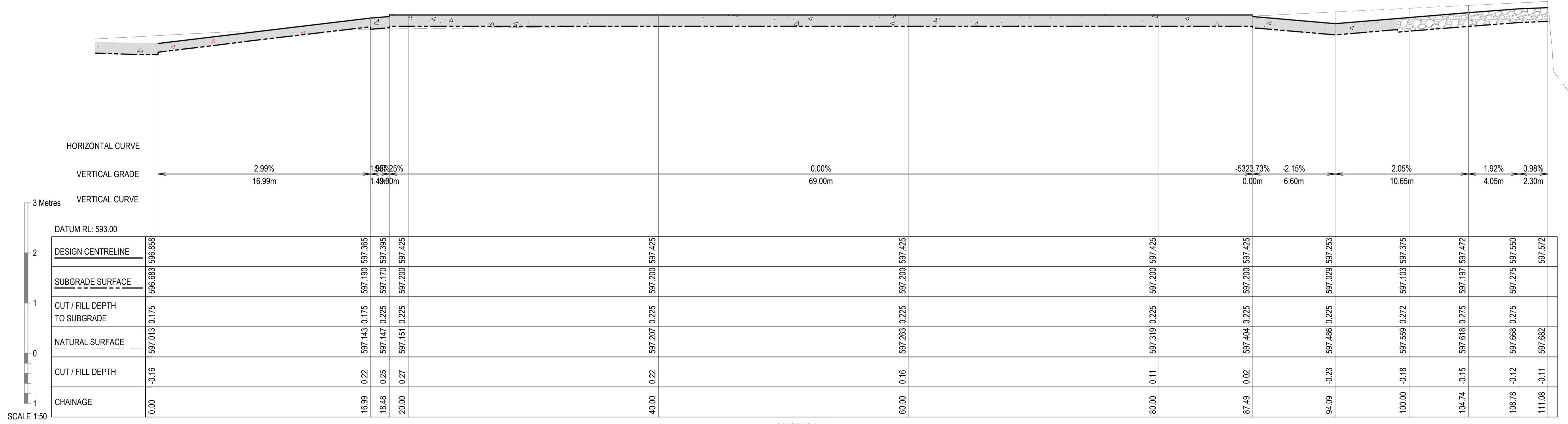
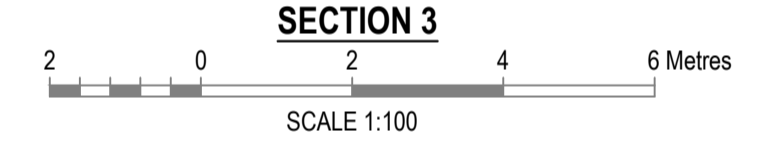
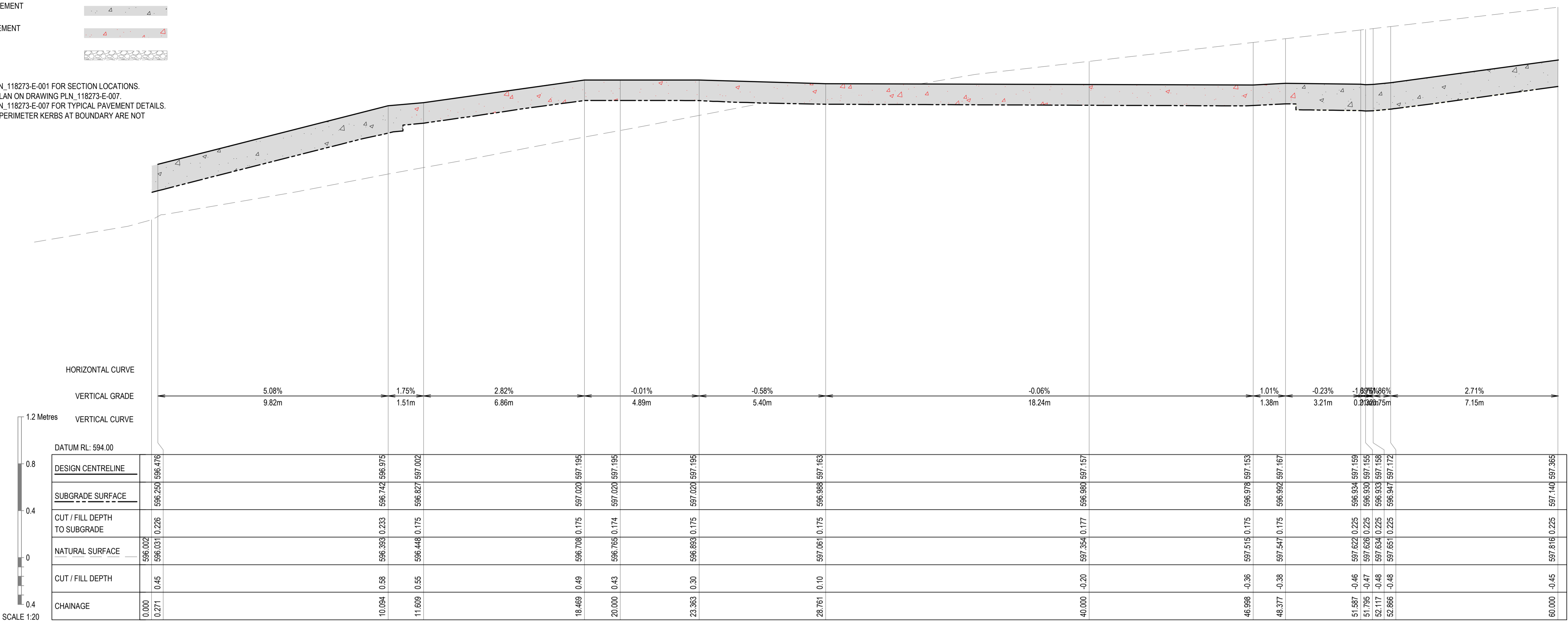

WARNING
 BEWARE OF UNDERGROUND SERVICES
 THE LOCATION OF UNDERGROUND CABLES ARE APPROXIMATE ONLY AND THEIR EXACT POSITION SHOULD BE CHECKED ON SITE. NO GUARANTEE IS GIVEN THAT ALL EXISTING CABLES AND SERVICES ARE SHOWN. LOCATE ALL UNDERGROUND CABLES AND SERVICES BEFORE COMMENCEMENT OF WORK. REFER TO WORKSAFE REGULATION 3.21.

DIAL 1100
 BEFORE YOU DIG

REV.	BY	DATE	DESCRIPTION
A	ZS/RS	2026.04.09	FOR APPROVAL

Copyright VPE CONSULTING PLY LTD. T: +61 8 6400 7433 | Email: admin@vpeconsulting.com.au



TITLE	EARTHWORKS SECTIONS LAYOUT SHEET 2 OF 3
PROJECT	LOT 4 ENDEAVOR WAY, TORRINGTON
DWG No.	PLN_118273-E-003

DATE	2026.04.09	REV	A
DRAWN	ZINALDU SWART		
DESIGNED	RIANDOR SWART		
CHECKED	ROBERT SMITH		
A1 SCALE	AS NOTED ON DRAWING		
JOB REF.	PLN_118273		

- LEGEND**
- HEAVY DUTY CONCRETE PAVEMENT (REFER TO NOTE 3)
 - GRAVEL PAVEMENT (REFER TO NOTE 3)

- GENERAL NOTES**
- REFER TO DRAWING PLN_118273-E-001 FOR SECTION LOCATIONS.
 - REFER TO PAVEMENT PLAN ON DRAWING PLN_118273-E-007
 - REFER TO DRAWING PLN_118273-E-007 FOR TYPICAL PAVEMENT DETAILS.
 - RETAINING WALLS AND PERIMETER KERBS AT BOUNDARY ARE NOT SHOWN ON SECTIONS.

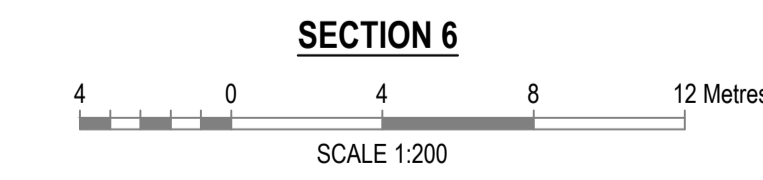
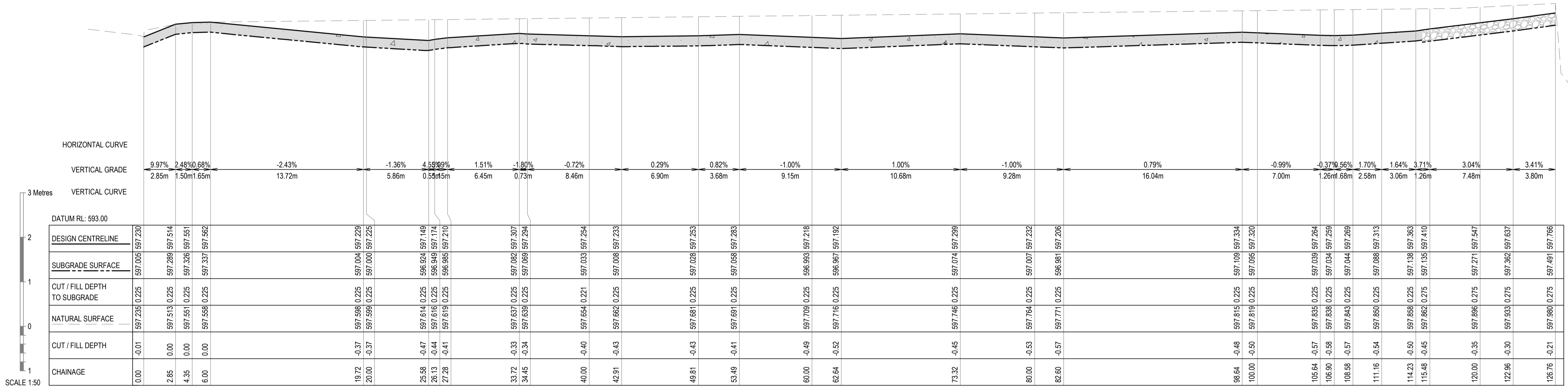
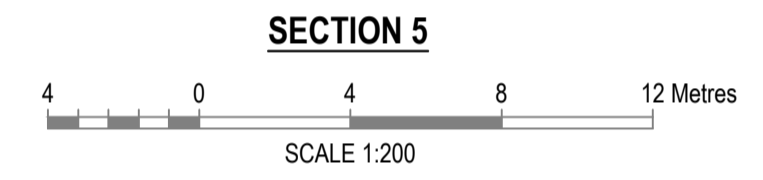
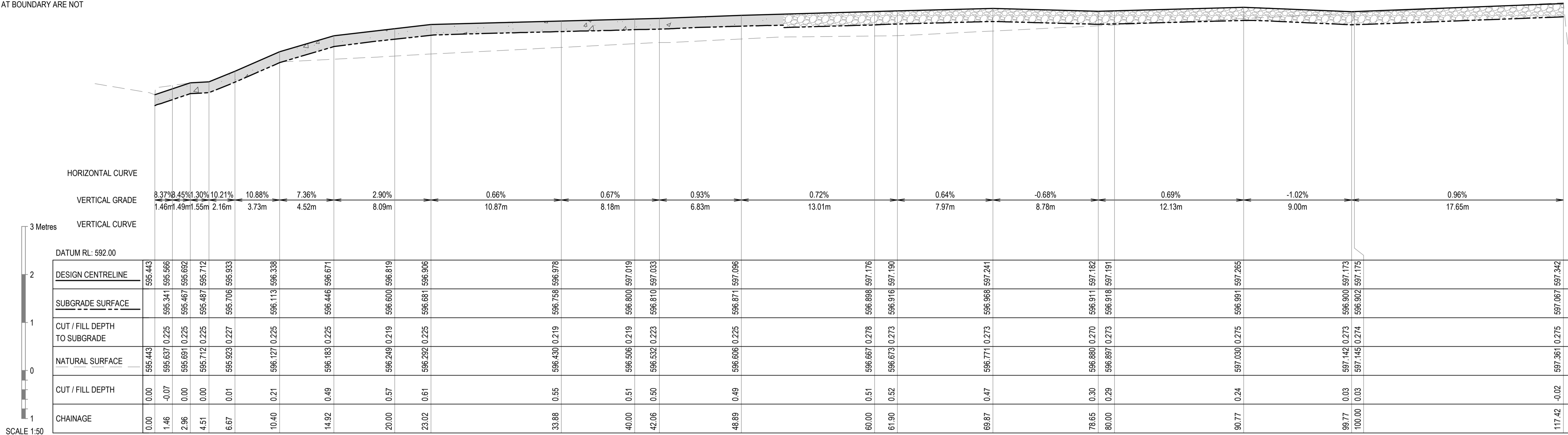

WARNING
BEWARE OF UNDERGROUND SERVICES
THE LOCATION OF UNDERGROUND CABLES ARE APPROXIMATE ONLY AND THEIR EXACT POSITION SHOULD BE CHECKED ON SITE. NO GUARANTEE IS GIVEN THAT ALL EXISTING CABLES AND SERVICES ARE SHOWN. LOCATE ALL UNDERGROUND CABLES AND SERVICES BEFORE COMMENCEMENT OF WORK. REFER TO WORKSAFE REGULATION 3.21.

DIAL 1100
BEFORE YOU DIG

REV.	BY	DATE	DESCRIPTION
A	ZS/RS	2026.04.09	FOR APPROVAL

Copyright VPE CONSULTING PLY LTD. T: +61 8 6400 7433 | Email: admin@vpeconsulting.com.au



TITLE	EARTHWORKS SECTIONS LAYOUT SHEET 3 OF 3	DATE	2026.04.09	REV	A
DRAWN	ZINALDU SWART	DESIGNED	RIANDOR SWART	CHECKED	ROBERT SMITH
PROJECT	LOT 4 ENDEAVOR WAY, TORRINGTON	A1 SCALE	AS NOTED ON DRAWING	JOB REF.	PLN_118273
DWG No.	PLN_118273-E-004				

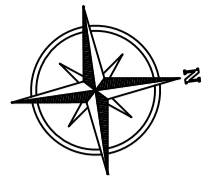

LEGEND

(EXISTING)

CADASTRAL BOUNDARY

ROAD

RETAINING WALL BY OTHER

FOOTPATH (PROPOSED)

EDGE OF SEAL

EDGE OF BUILDING

RETAINING WALL (REFER TO IMPACT ENGINEERS FOR STRUCTURAL DETAILS)

PAVEMENT DRAIN (ARROW INDICATES DIRECTION OF FLOW)

- ASSUMPTIONS**
- EARTHWORKS VOLUMES ARE FROM EXISTING SURFACE TO BOTTOM OF SUBGRADE BOXING OR FINISHED SURFACE LEVEL WHERE APPLICABLE. VOLUMES ARE SOLID IN GROUND AND DO NOT TAKE INTO ACCOUNT COMPACTION. THE CONTRACTOR IS TO MAKE HIS OWN ASSESSMENT OF A SUITABLE BULKING FACTOR.
 - NO TOPSOIL STRIPPING WAS ALLOWED FOR

- GENERAL NOTES**
- ALL DIMENSIONS IN METRES U.N.O.
 - ALL DRAWINGS SHALL BE READ IN CONJUNCTION WITH SPECIFICATION.
 - CONTRACTORS TO UNDERTAKE A DILAPIDATION SURVEY OF ALL BUILDING WITHIN 30m OF THE SITE'S BOUNDARIES PRIOR TO COMMENCEMENT OF CONSTRUCTION.
 - CONTRACTOR TO MAINTAIN ACCESS TO EXISTING LOTS AT ALL TIMES DURING CONSTRUCTION.
 - A DUST MANAGEMENT PLAN MUST BE SUBMITTED AND APPROVED BY COUNCIL. THE CONTRACTOR MUST ADHERE TO THE APPROVED DUST MANAGEMENT PLAN.

CUT / FILL DEPTHS

COLOR	MINIMUM ELEVATION (m)	MINIMUM ELEVATION (m)
Lightest Yellow	-2.6	-2.4
Yellow	-2.4	-2.2
Light Orange	-2.2	-2.0
Orange	-2.0	-1.8
Light Red	-1.8	-1.6
Red	-1.6	-1.4
Dark Red	-1.4	-1.2
Light Purple	-1.2	-1.0
Purple	-1.0	-0.8
Light Blue	-0.8	-0.6
Blue	-0.6	-0.4
Light Green	-0.4	-0.2
Green	0	0.2
Light Green	0.2	0.4
Green	0.4	0.6
Light Green	0.6	0.8
Green	0.8	1.0
Light Green	1.0	1.2
Green	1.2	1.4
Light Green	1.4	1.6
Green	1.6	1.8
Dark Green	1.8	2.0

CUT AND FILL BULK EARTHWORK QUANTITIES

CUT	1959m ³
FILL	482m ³

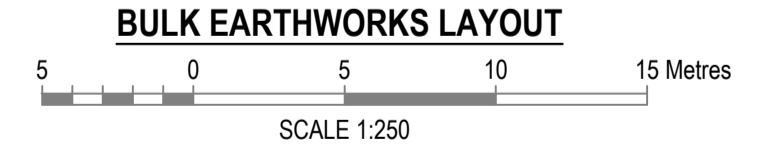
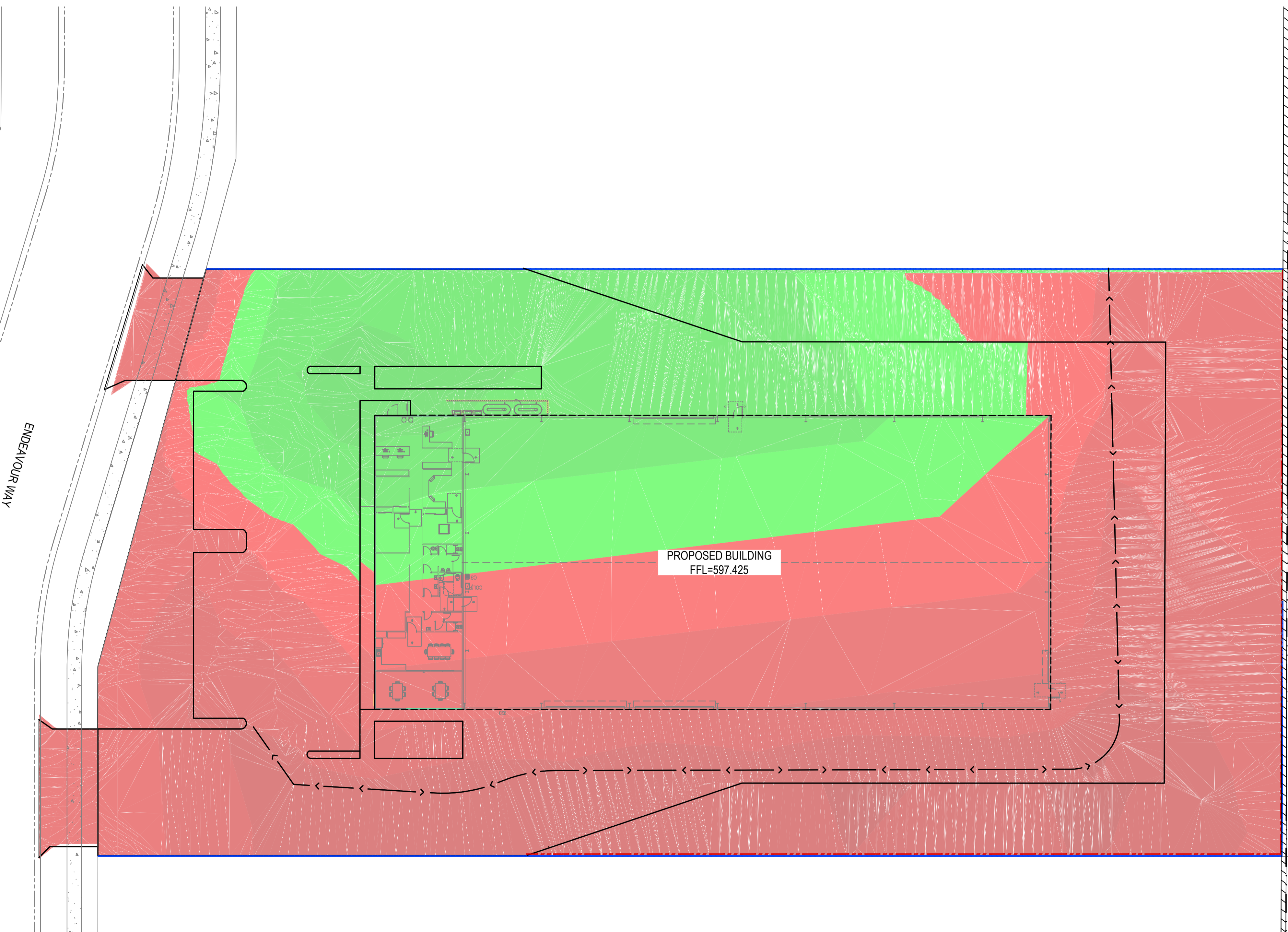

WARNING
BEWARE OF UNDERGROUND SERVICES
THE LOCATION OF UNDERGROUND CABLES ARE APPROXIMATE ONLY AND THEIR EXACT POSITION SHOULD BE CHECKED ON SITE. NO GUARANTEE IS GIVEN THAT ALL EXISTING CABLES AND SERVICES ARE SHOWN. LOCATE ALL UNDERGROUND CABLES AND SERVICES BEFORE COMMENCEMENT OF WORK. REFER TO WORKSAFE REGULATION 3.21.

DIAL 1100
BEFORE YOU DIG

REV.	BY	DATE	DESCRIPTION
A	ZS/RS	2026.04.09	FOR APPROVAL

Copyright VPE CONSULTING PLY LTD. T: +61 8 6400 7433 | Email: admin@vpeconsulting.com.au



TITLE	BULK EARTHWORKS LAYOUT	DATE	2026.04.09	REV	A
DRAWN	ZINALDU SWART	DESIGNED	RIANDOR SWART	CHECKED	ROBERT SMITH
PROJECT	LOT 4 ENDEAVOR WAY, TORRINGTON	A1 SCALE	AS NOTED ON DRAWING	JOB REF.	PLN_118273
DWG No.	PLN_118273-E-005				

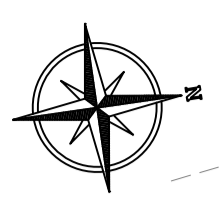

GENERAL NOTES
 1. ALL DIMENSIONS IN METRES U.N.O
 2. REFER TO PLN_118273-E-001 FOR DETAILS.

LEGEND

(EXISTING)	
CAADSTRAL BOUNDARY	---
ROAD	---
SEWER	-s-s-
WATER	-w-w-
NATURAL CONTOURS 0.2 INTERVALS	-596.2-
DRAINAGE	-d-d-
SEWER MH	○
DRAINAGE MH	○
SIDE ENTRY PIT	○
RETAINING WALL BY OTHER	▨
FOOTPATH (PROPOSED)	---
DESIGN CONTOURS 0.1m INTERVALS	-597.2-
EDGE OF SEAL	---
RETAINING WALL (REFER TO IMPACT STRUCTURAL ENGINEERS FOR DETAIL)	---
PAVEMENT DRAIN (ARROW INDICATES DIRECTION OF FLOW)	→
PAVEMENT DRAIN (ARROW INDICATES DIRECTION OF FLOW)	→ HP
LANDSCAPING	▨
CROSSOVER TO BE CONSTRUCTED IN ACCORDANCE TO DRAWING RSD-102	▨
BUILDING	▨
CONCRETE (REFER TO GENERAL NOTE 2)	▨
GRAVEL AREA (REFER TO GENERAL NOTE 2)	▨
FOOTPATH	---
WHEELSTOPS TO AS 2890.1	---
SILT FENCE REFER TO SEDIMENT FENCE DETAIL	---
SEDIMENT DIVERSION BUND	---

- LAND MANAGEMENT NOTES**
1. THE CONTRACTOR IS TO TAKE ALL NECESSARY PRECAUTIONS TO CONTROL EROSION AND DOWNSTREAM SEDIMENTATION DURING ALL STAGES OF CONSTRUCTION INCLUDING THE MAINTENANCE PERIOD.
 2. ALL SEDIMENT CONTROL DEVICES SHALL BE MONITORED, CLEANED AND/OR REPAIRED WHENEVER THE ACCUMULATED SEDIMENT REDUCES THE CAPACITY BY 50% SATISFACTION OF SOUTHERN DOWNS REGIONAL COUNCIL'S OFFICER.
 3. ALL PERIMETER BANKSWALE SHALL HAVE UNINTERRUPTED POSITIVE GRADE TO AN OUTLET. TO THE SATISFACTION OF SOUTHERN DOWNS REGIONAL COUNCIL'S OFFICER.
 4. AT ALL TIMES THE CONTRACTOR SHALL MONITOR THE PREVAILING WEATHER CONDITIONS AND PROTECT ANY DOWNSTREAM CONSTRUCTION TO THE GULLY INLETS. TO THE SATISFACTION OF SOUTHERN DOWNS REGIONAL COUNCIL'S OFFICER.
 5. INLETS TO HAVE SILT PROTECTION IN ACCORDANCE WITH KERB INLET PROTECTION DETAIL AT LOCATIONS SHOWN OR AS DIRECTED BY THE ENGINEER.
 6. THE EXTENT OF GRASSING SHALL BE DETERMINED BY THE ENGINEER AND SHALL BE SEED, AS SPECIFIED, WITHIN SEVEN DAYS OF FINAL TRIMMING.
 7. EXTRA EROSION CONTROLS ARE TO BE ERRECTED AS ORDERED BY THE SUPERINTENDENT.
 8. CLEARING OF SITE AND STOCK PILE AREAS TO BE AS DIRECTED BY THE SUPERINTENDENT.
 9. SUITABLE DUST CONTROL IS TO BE IMPLEMENTED AT ALL TIMES INCLUDING WEEKENDS AND PUBLIC HOLIDAYS.
 10. CONSTRUCT WASH DOWN BAY OR SHAKE DOWN AT ENTRY/EXIT TO COMPLY WITH IPWEAQ STANDARD DRAWING DS-040 AND TO THE SATISFACTION OF COUNCIL'S OFFICER.

- EXISTING SERVICES NOTE**
1. CONTRACTOR TO CONFIRM LOCATION AND DEPTH OF ALL INGROUND SERVICES PRIOR TO ANY EXCAVATION. REFER TO SITE CIVIL WORKS LAYOUTS FOR APPROXIMATE LOCATION OF KNOWN SERVICES.

- SEDIMENT FENCE NOTES**
1. FILTER CLOTH TO BE FASTENED SECURELY TO POSTS WITH GALVANISED WIRE TIES, STAPLES OR ATTACHMENT BELTS.
 2. POSTS SHOULD NOT BE SPACED MORE THAN 2.0m APART.
 3. WHEN TWO SECTIONS OF FILTER CLOTH ADJOIN EACH OTHER THEY SHALL BE OVERLAPPED BY 150mm AND FOLDED.
 4. FOR EXTRA STRENGTH TO SILT FENCE, WOVEN WIRE (14mm GAUGE, 150mm MESH SPACING) TO BE FASTENED SECURELY BETWEEN FILTER CLOTH AND POSTS BY WIRE TIES OR STAPLES.
 5. INSPECTIONS SHALL BE PROVIDED ON A REGULAR BASIS, ESPECIALLY AFTER RAINFALL AND EXCESSIVE SILT DEPOSITS REMOVED WHEN 'BULGES' DEVELOP IN SILT FENCE.
 6. SEDIMENT FENCES SHALL BE CONSTRUCTED WITH SEDIMENT TRAPS AND EMERGENCY SPILLWAYS AT SPACINGS NO GREATER THAN 40m ON FLAT TERRAIN DECREASING TO 20m SPACINGS ON STEEP TERRAIN.

- SILT MANAGEMENT PROGRAM PHASE DESCRIPTION**
- | | |
|--------------------|---|
| CLEARING | * EARTH BANK AND TABLE DRAIN TO BE CONSTRUCTED ALONG THE TOP OF THE EXISTING BATTER.
* SEDIMENT FENCE, SAND BAGS AND EARTH RILLS TO BE ERRECTED AS INDICATED OR REQUIRED. |
| EARTHWORKS | * EXISTING GRASSSED AREAS TO BE KEPT WHERE POSSIBLE.
* SEDIMENT FENCES AND EARTH RILLS WITHIN ROADS TO BE ERRECTED AS INDICATED OR REQUIRED. |
| STORMWATER | * EXCAVATED MATERIAL TO BE PLACED ON HIGH SIDE OF TRENCH AND TO PROTECT PIPE WORK AND DIRECT SURFACE MATERIAL AWAY FROM EXCAVATIONS.
* TOPSOIL AND GRASS SEED AREAS IN ALLOTMENTS IMMEDIATELY AFTER COMPLETING THE SEWER AND ROOFWATER DRAINAGE CONSTRUCTION.
* DEPRESS GROUND AROUND TEMPORARY FIELD INLETS TO CREATE SILT POND. |
| STOCKPILE | * SEDIMENT FENCE TO BE ERRECTED 5M FROM TOE OF BATTER ON LOW SIDE OF STOCKPILE. |
| ROADWORKS | * SEDIMENT FENCES TO ALLOTMENTS TO BE ERRECTED.
* KERB INLET PROTECTION TO BE PROVIDED.
* SAND BAGS SURROUND SAG GULLY PITS AS INDICATED. |
| ALLOTMENTS | * TOPSOIL AND SEED FILL WITHIN ALLOTMENTS.
* SEDIMENT FENCES TO ALLOTMENTS TO BE RE-ERRECTED.
* COVERS TO GULLY GRATES TO BE REMOVED IF THE SUPERINTENDENT INDICATES THE GRASS STRIKE IS SUFFICIENT. |
| MAINTENANCE | * THE SEDIMENT FENCES ARE TO BE INSPECTED WEEKLY. ANY REPAIRS REQUIRED ARE TO BE ERRECTED IMMEDIATELY. SEDIMENT AFTER RAIN IS TO BE CLEANED FROM STREETS AND ALLOTMENTS IMMEDIATELY AND CORRECTIVE ACTION TAKEN TO AVOID A RE-OCCURENCE OF THE FAILURE. |

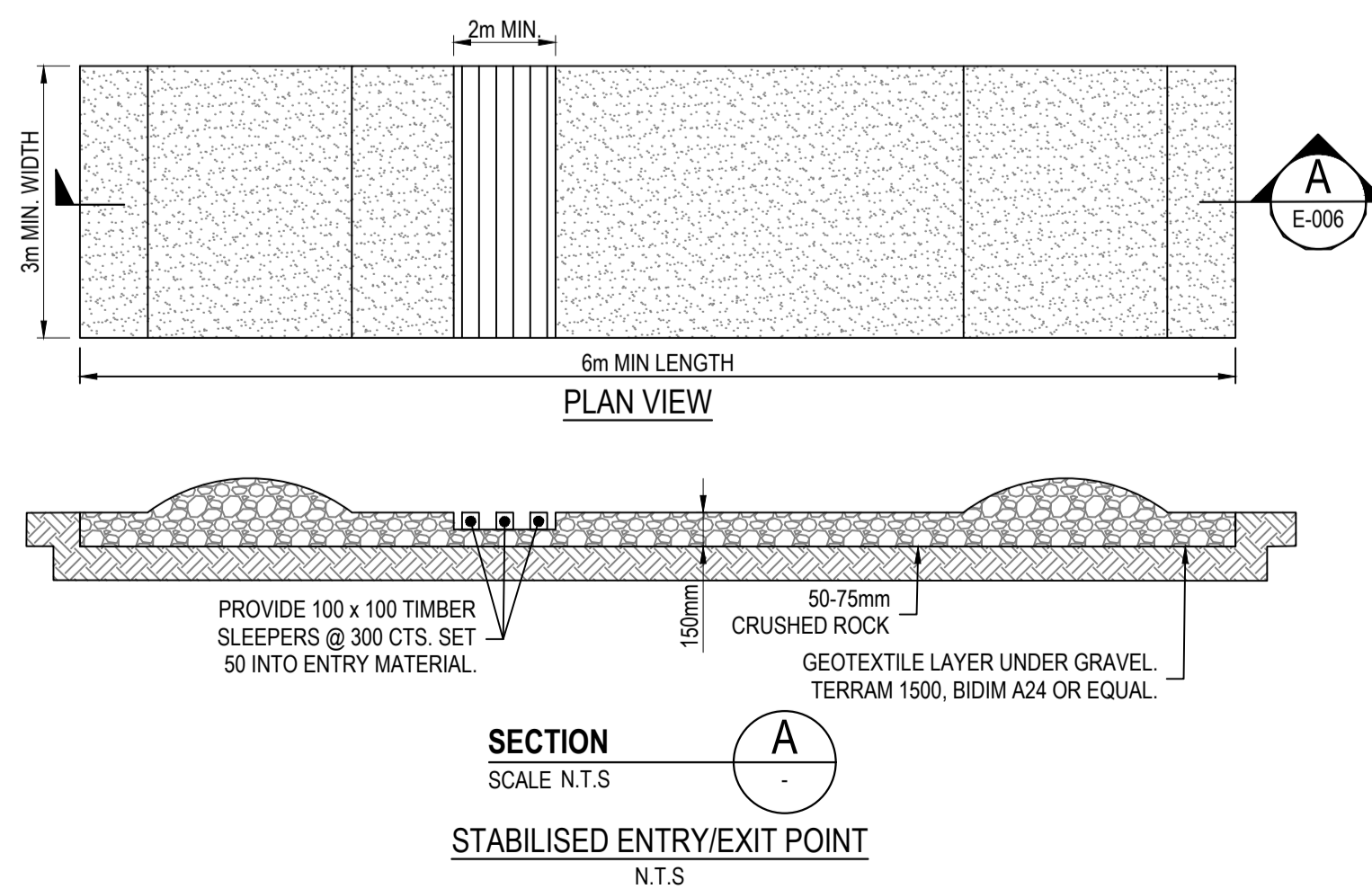
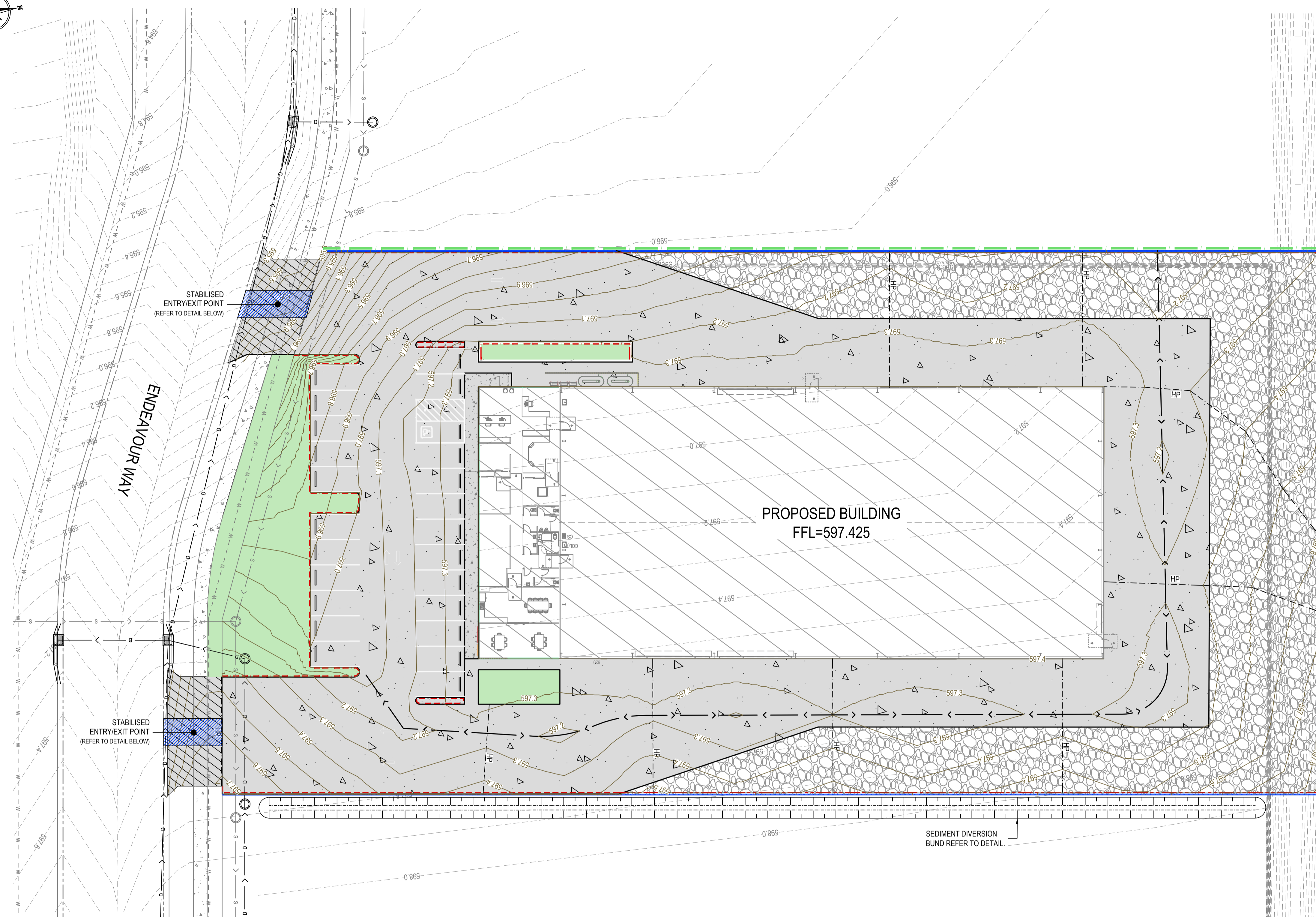

SOIL AND SEDIMENTATION PLAN
 SCALE 1:250

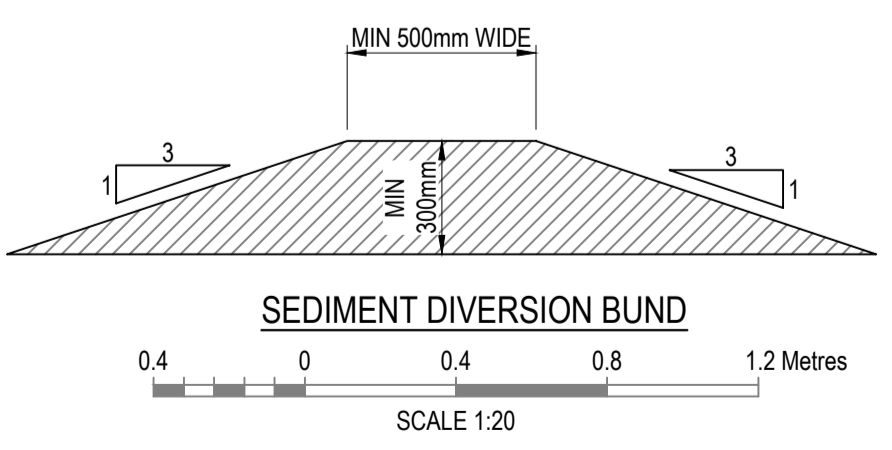
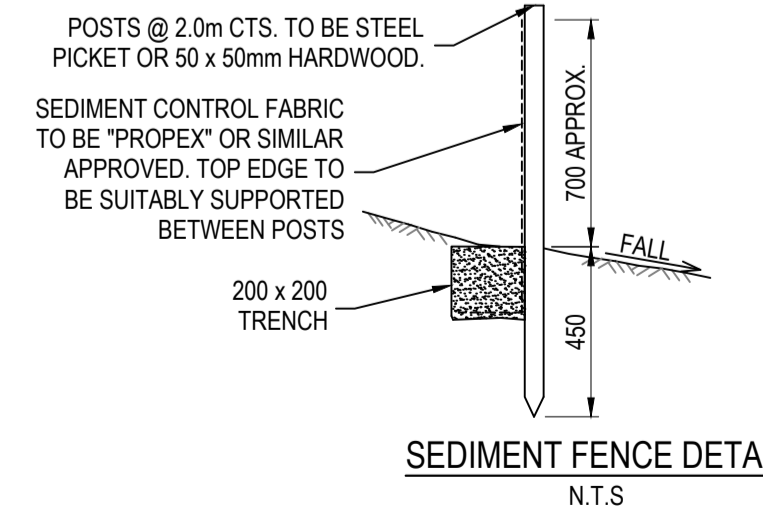

WARNING
 BEWARE OF UNDERGROUND SERVICES
 THE LOCATION OF UNDERGROUND CABLES ARE APPROXIMATE ONLY AND THEIR EXACT POSITION SHOULD BE CHECKED ON SITE. NO GUARANTEE IS GIVEN THAT ALL EXISTING CABLES AND SERVICES ARE SHOWN. LOCATE ALL UNDERGROUND CABLES AND SERVICES BEFORE COMMENCEMENT OF WORK. REFER TO WORKSAFE REGULATION 3.21.

REV.	BY	DATE	DESCRIPTION
A	ZS/RS	2026.04.09	FOR APPROVAL

Copyright VPE CONSULTING PLY LTD. T: +61 8 6400 7433 | Email: admin@vpeconsulting.com.au



TITLE	SOIL AND SEDIMENTATION PLAN	DATE	2026.04.09	REV	A
DRAWN	ZINALDU SWART				
DESIGNED	RIANDOR SWART				
CHECKED	ROBERT SMITH				
A1 SCALE	AS NOTED ON DRAWING				
DWG No.	PLN_118273-E-006	JOB REF.	PLN_118273		

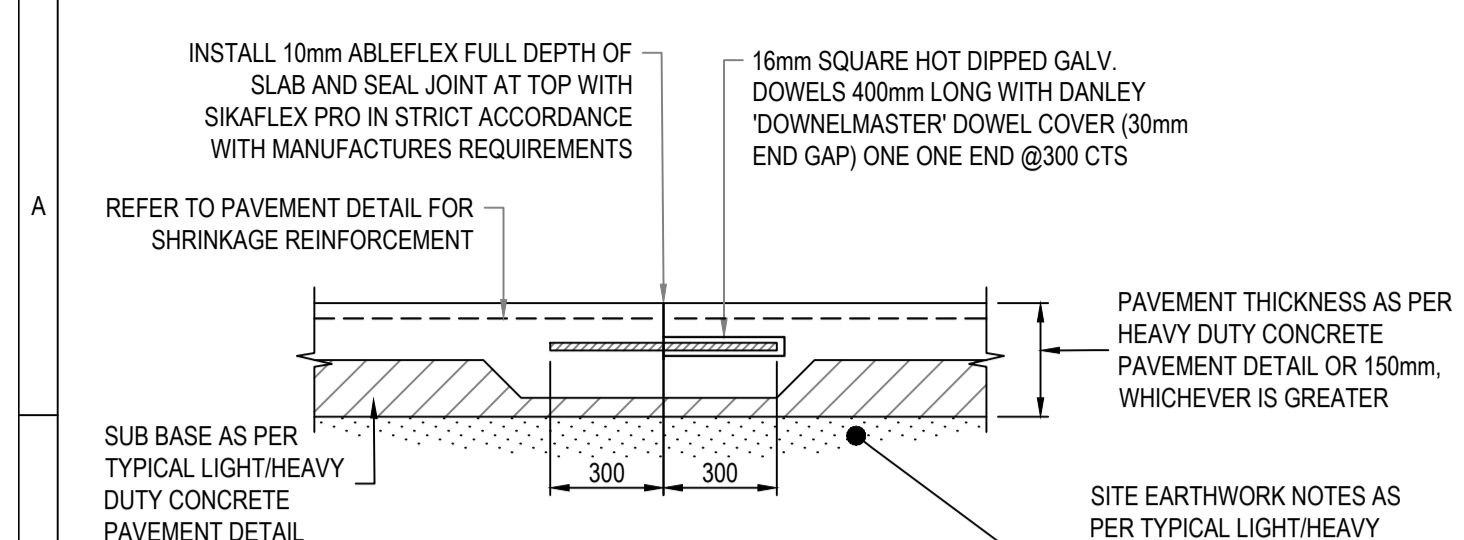

TYPICAL DOWEL JOINT DETAIL
TO BE PLACED AT AT MAXIMUM 15m CENTERS

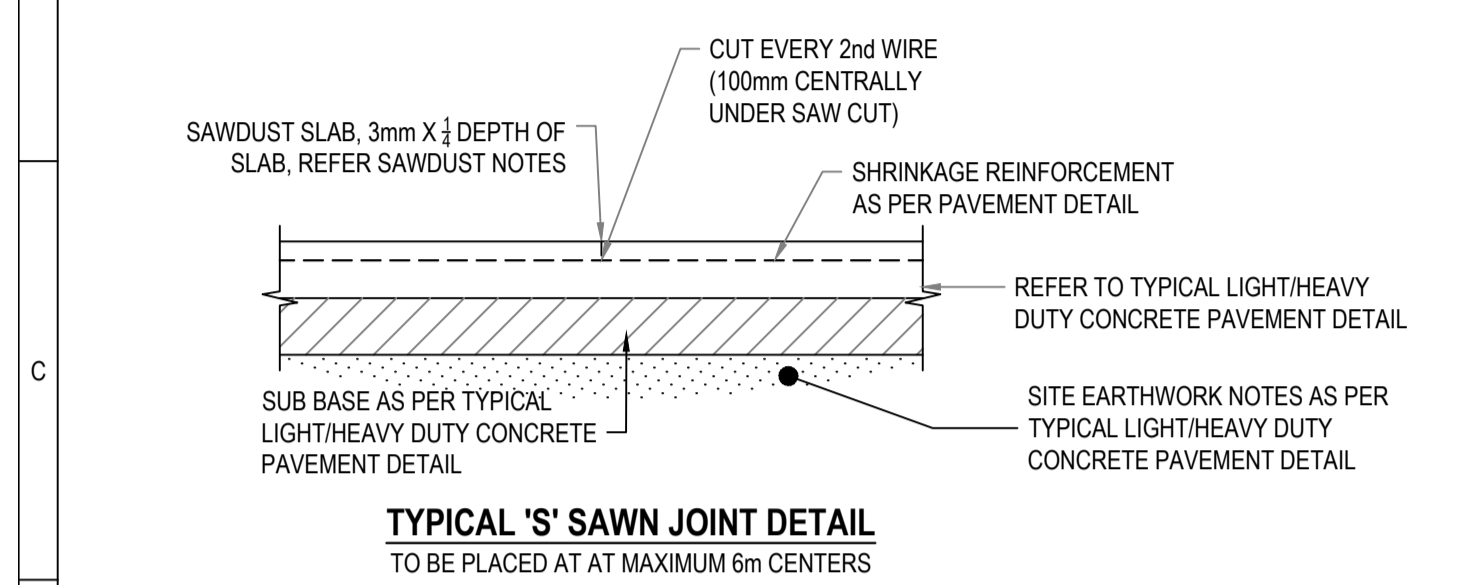

TYPICAL 'S' SAWN JOINT DETAIL
TO BE PLACED AT AT MAXIMUM 6m CENTERS

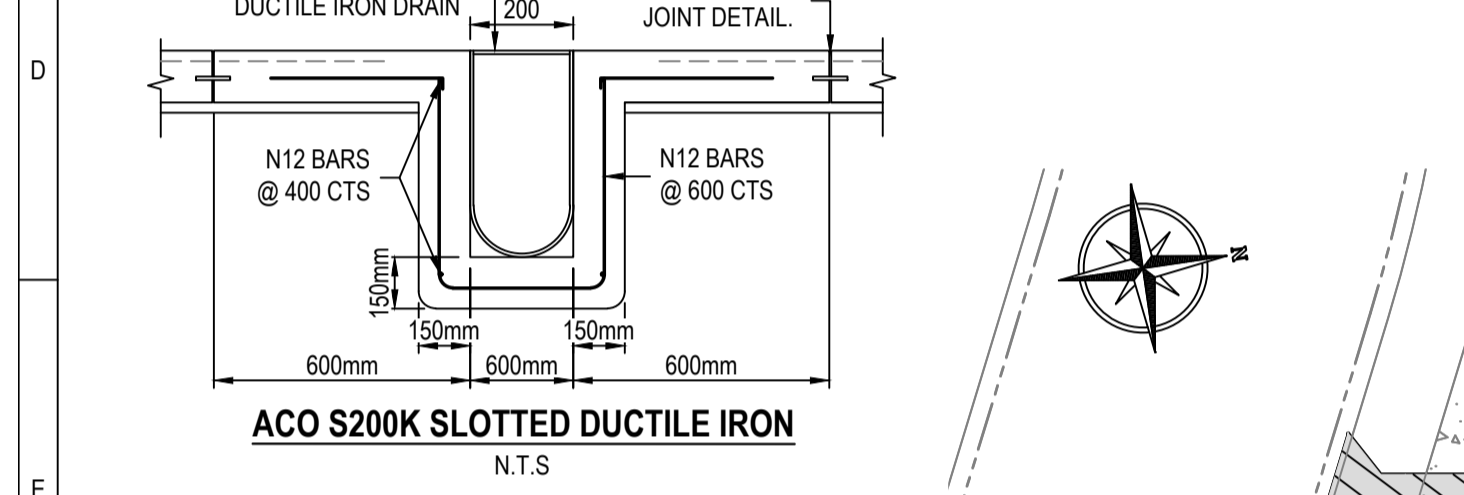

ACO S200K SLOTTED DUCTILE IRON
N.T.S

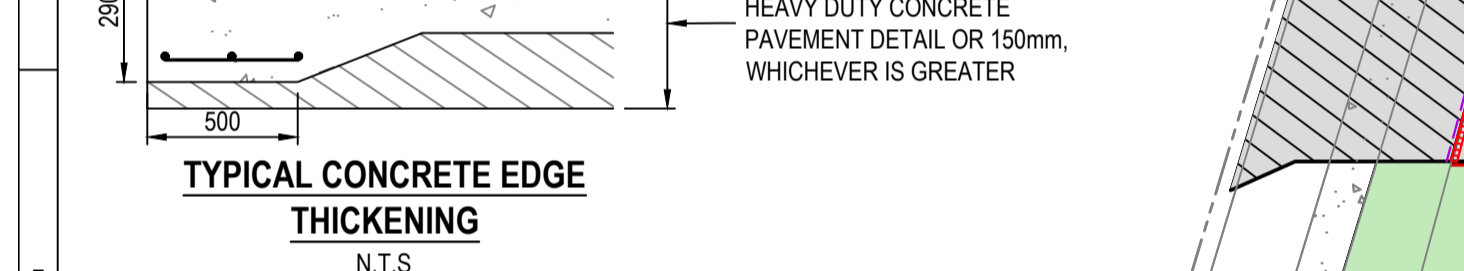

TYPICAL CONCRETE EDGE THICKENING
N.T.S

DESIGN ASSUMPTIONS
*CBR OF 6% HAS BEEN ACHIEVED
*10.8 TONNE AXLE AND 400 000 AXLE MOVEMENTS

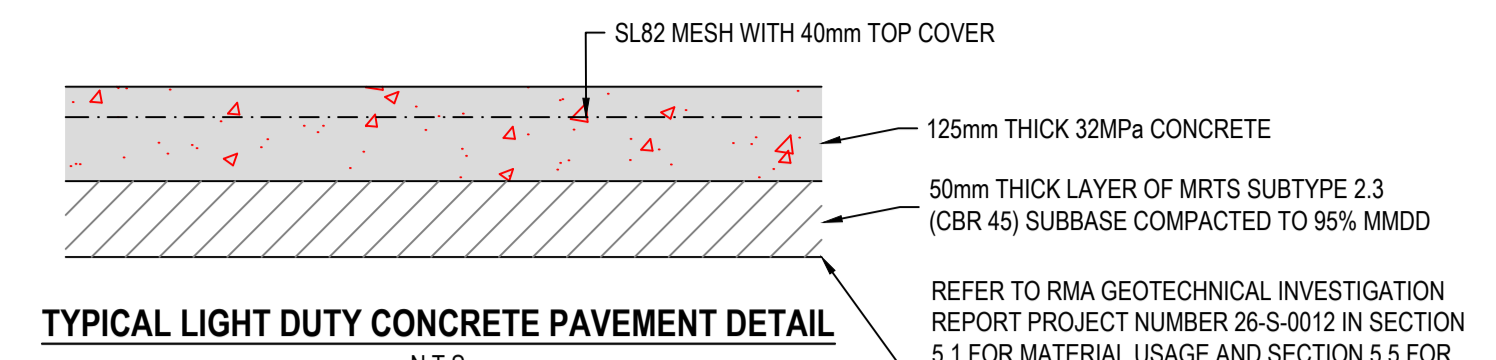

TYPICAL LIGHT DUTY CONCRETE PAVEMENT DETAIL
N.T.S

DESIGN ASSUMPTIONS
*CBR OF 6% HAS BEEN ACHIEVED
*2 TONNE AXLE AND 400 000 AXLE MOVEMENTS

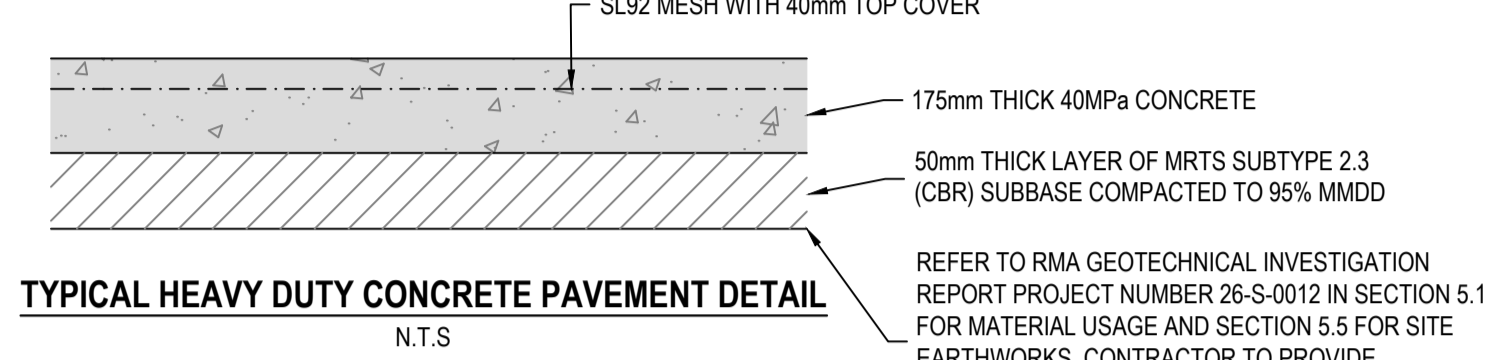

TYPICAL HEAVY DUTY CONCRETE PAVEMENT DETAIL
N.T.S

DESIGN ASSUMPTIONS
*CBR OF 6% HAS BEEN ACHIEVED
*10.8 TONNE AXLE AND 400 000 AXLE MOVEMENTS

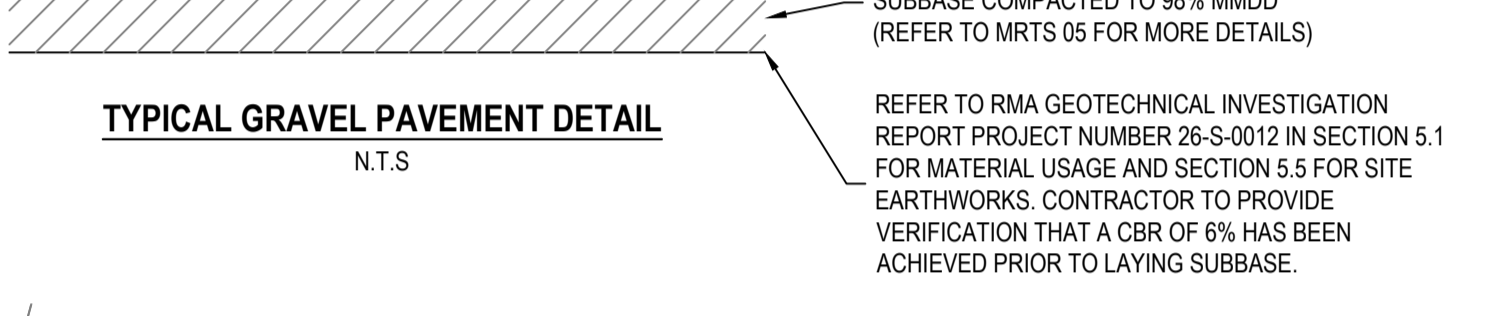

TYPICAL GRAVEL PAVEMENT DETAIL
N.T.S

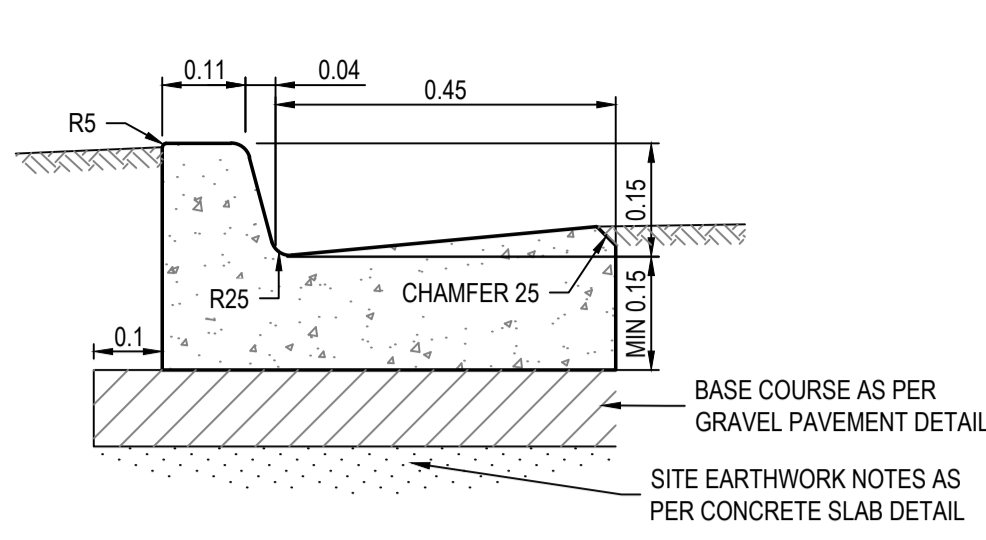

BARRIER KERB WITH CHANNEL-TYPE 7
REFER TO DEPARTMENT OF TRANSPORT AND MAIN ROADS KERB AND CHANNEL PROFILES DRAWINGS 1033

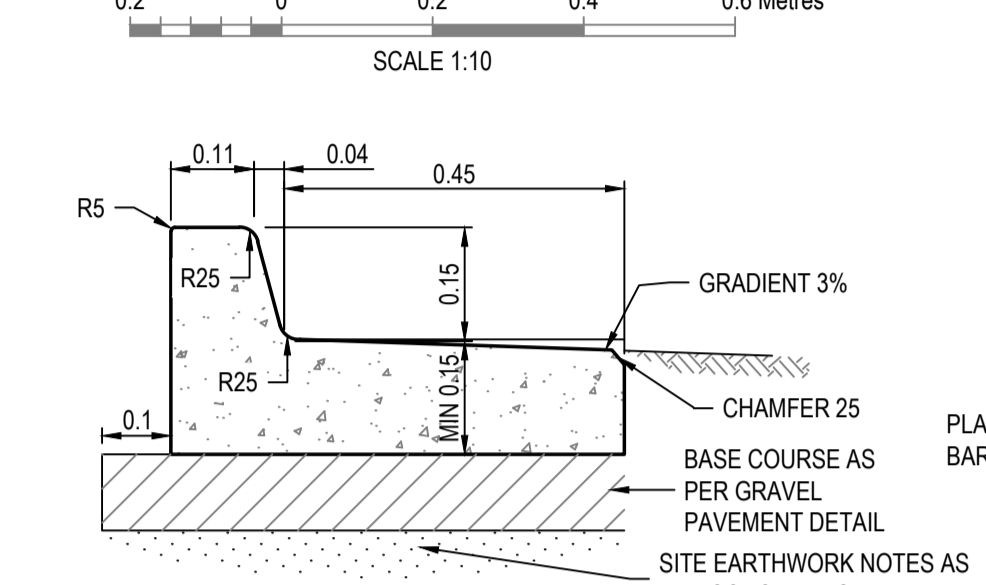

BARRIER KERB WITH CHANNEL-TYPE 24
REFER TO DEPARTMENT OF TRANSPORT AND MAIN ROADS KERB AND CHANNEL PROFILES DRAWINGS 1033

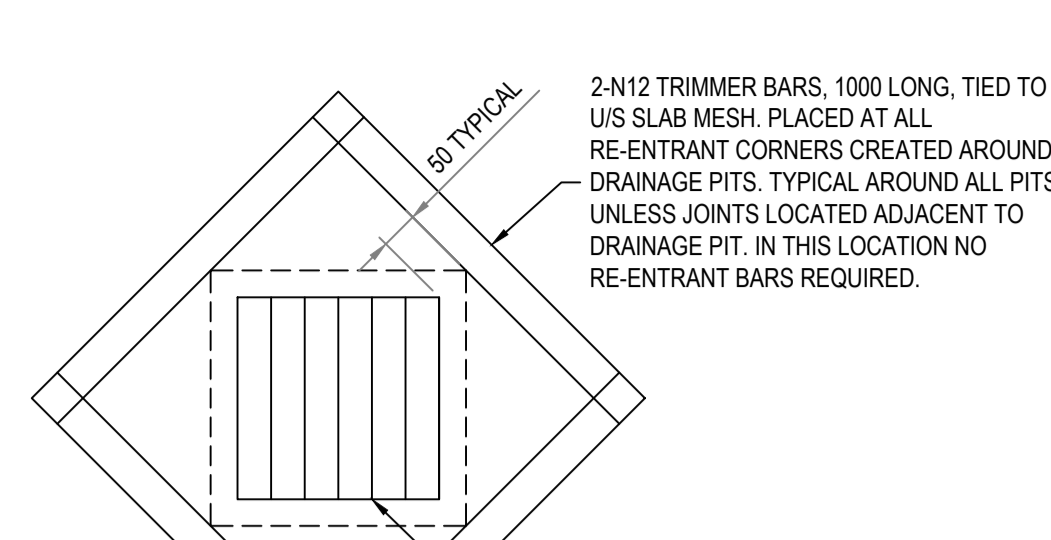

RE-ENTRANT BARS TO DRAINAGE GRATE
SCALE 1:10

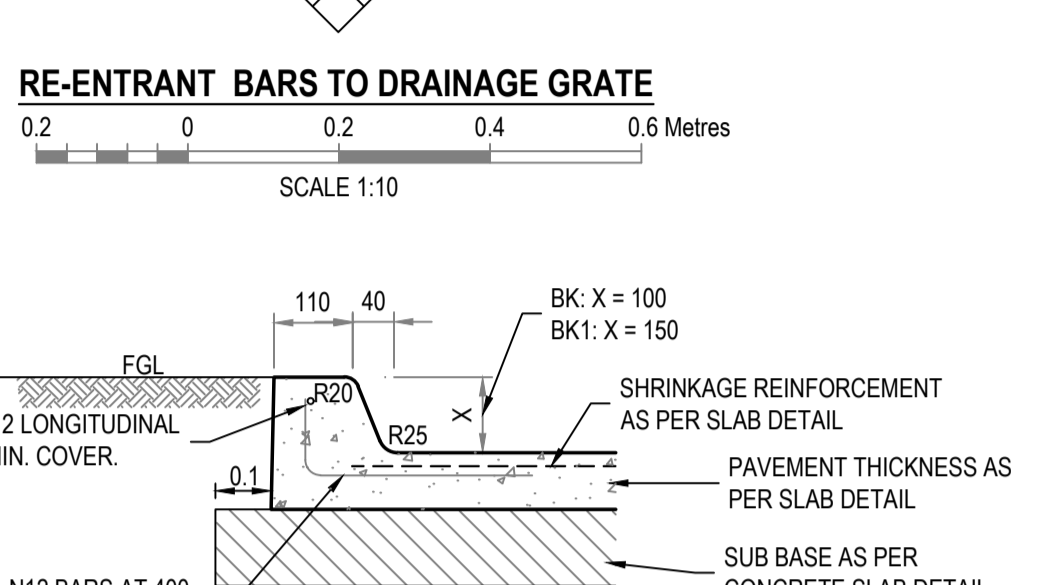

'BK&BK1' BARRIER KERB DETAIL
SCALE 1:10

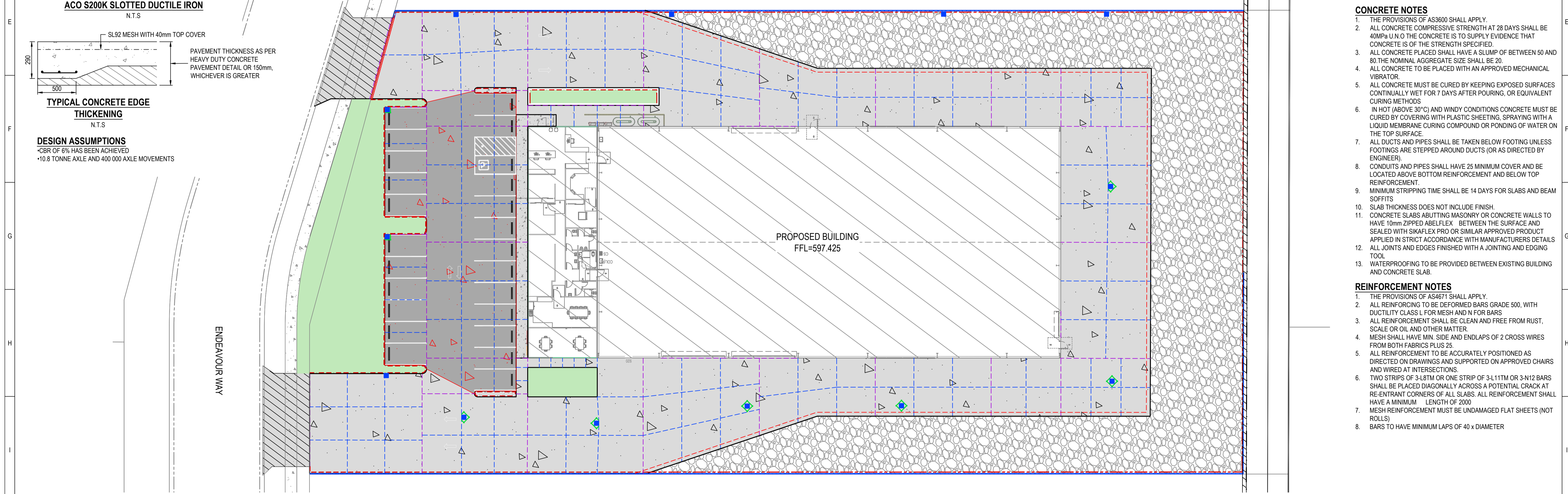
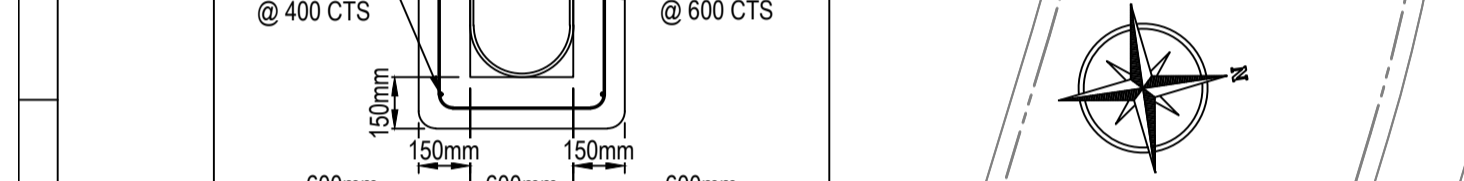

PAVEMENT AND CONCRETE JOINTING PLAN

SCALE 1:250

WARNING
BEWARE OF UNDERGROUND SERVICES
THE LOCATION OF UNDERGROUND CABLES ARE APPROXIMATE ONLY AND THEIR EXACT POSITION SHOULD BE CHECKED ON SITE. NO GUARANTEE IS GIVEN THAT ALL EXISTING CABLES AND SERVICES ARE SHOWN. LOCATE ALL UNDERGROUND CABLES AND SERVICES BEFORE COMMENCEMENT OF WORK. REFER TO WORKSAFE REGULATION 3.21.

REV.	BY	DATE	DESCRIPTION
A	ZS/RS	2026.04.09	FOR APPROVAL



TITLE	PAVEMENT AND CONCRETE JOINTING PLAN
PROJECT	LOT 4 ENDEAVOR WAY, TORRINGTON
DWG No.	PLN_118273-E-007

DATE	2026.04.09	REV	A
DRAWN	ZINALDU SWART		
DESIGNED	RIANDOR SWART		
CHECKED	ROBERT SMITH		
AS SCALE	AS NOTED ON DRAWING		
JOB REF.	PLN_118273		

LEGEND

(EXISTING)

CADAstral BOUNDARY

ROAD

RETAINING WALL BY OTHER

FOOTPATH (PROPOSED)

EDGE OF SEAL

RETAINING WALL (REFER TO IMPACT STRUCTURAL ENGINEERS FOR DETAIL)

0.1m HIGH IN-SITU CONCRETE "BK" (REFER TO GENERAL NOTE 2)

0.15m HIGH IN-SITU CONCRETE "BK1" (REFER TO GENERAL NOTE 2)

BARRIER KERB TYPE 7 "BK7" (REFER TO GENERAL NOTE 3)

BARRIER KERB TYPE 24 "BK24" (REFER TO GENERAL NOTE 2)

DOWEL JOINT

SAWN JOINT

EDGE THICKENING (REFER TO EDGE THICKENING DETAIL)

RE-ENTRANT BARS

LANDSCAPING

BUILDING

HEAVY DUTY CONCRETE PAVEMENT (REFER TO DETAIL BELOW)

LIGHT DUTY CONCRETE PAVEMENT (REFER TO DETAIL BELOW)

GRAVEL PAVEMENT (REFER TO DETAIL BELOW)

FOOTPATH

WHEELSTOPS TO AS 2890.1

RKO PITS (REFER TO PLN_118273-D-001_A FOR DETAILS)

200mm WIDE ACO S200K SLOPED CHANNEL STRIP DRAIN WITH CLASS D GRATE (REFER TO GENERAL NOTE 7)

GENERAL NOTES
1. ALL DIMENSIONS SHOWN ARE IN METRES U.N.O

JOINT NOTES
1. CONCRETE SLABS, ABUTTING MASONRY OR CONCRETE WALLS TO HAVE 10mm ZIPPED ABLEFLEX BETWEEN THE SURFACE AND SEALED WITH SIKAFLEX PRO OR SIMILAR APPROVED PRODUCT IN STRICT ACCORDANCE WITH MANUFACTURERS DETAILS.
2. JOINTS IN KERB TO MATCH JOINTS IN SLAB.
3. PLANS TO BE PRINTED IN COLOUR.

CONCRETE NOTES
1. THE PROVISIONS OF AS3600 SHALL APPLY.
2. ALL CONCRETE COMPRESSIVE STRENGTH AT 28 DAYS SHALL BE 40MPa U.N.O THE CONCRETE IS TO SUPPLY EVIDENCE THAT CONCRETE IS OF THE STRENGTH SPECIFIED.
3. ALL CONCRETE PLACED SHALL HAVE A SLUMP OF BETWEEN 50 AND 80, THE NOMINAL AGGREGATE SIZE SHALL BE 20.
4. ALL CONCRETE TO BE PLACED WITH AN APPROVED MECHANICAL VIBRATOR.
5. ALL CONCRETE MUST BE CURED BY KEEPING EXPOSED SURFACES CONTINUALLY WET FOR 7 DAYS AFTER POURING, OR EQUIVALENT CURING METHODS.
6. IN HOT (ABOVE 30°C) AND WINDY CONDITIONS CONCRETE MUST BE CURED BY COVERING WITH PLASTIC SHEETING, SPRAYING WITH A LIQUID MEMBRANE CURING COMPOUND OR PONDING OF WATER ON THE TOP SURFACE.
7. ALL DUCTS AND PIPES SHALL BE TAKEN BELOW FOOTING UNLESS FOOTINGS ARE STEPPED AROUND DUCTS (OR AS DIRECTED BY ENGINEER).
8. CONDUITS AND PIPES SHALL HAVE 25 MINIMUM COVER AND BE LOCATED ABOVE BOTTOM REINFORCEMENT AND BELOW TOP REINFORCEMENT.
9. MINIMUM STRIPPING TIME SHALL BE 14 DAYS FOR SLABS AND BEAM SOFFITS.
10. SLAB THICKNESS DOES NOT INCLUDE FINISH.
11. CONCRETE SLABS ABUTTING MASONRY OR CONCRETE WALLS TO HAVE 10mm ZIPPED ABLEFLEX BETWEEN THE SURFACE AND SEALED WITH SIKAFLEX PRO OR SIMILAR APPROVED PRODUCT APPLIED IN STRICT ACCORDANCE WITH MANUFACTURERS DETAILS
12. ALL JOINTS AND EDGES FINISHED WITH A JOINTING AND EDGING TOOL.
13. WATERPROOFING TO BE PROVIDED BETWEEN EXISTING BUILDING AND CONCRETE SLAB.

REINFORCEMENT NOTES
1. THE PROVISIONS OF AS4671 SHALL APPLY.
2. ALL REINFORCING TO BE DEFORMED BARS GRADE 500, WITH DUCTILITY CLASS L FOR MESH AND N FOR BARS
3. ALL REINFORCEMENT SHALL BE CLEAN AND FREE FROM RUST, SCALE OR OIL AND OTHER MATTER.
4. MESH SHALL HAVE MIN. SIDE AND ENDLAPS OF 2 CROSS WIRES FROM BOTH FABRICS PLUS 25.
5. ALL REINFORCEMENT TO BE ACCURATELY POSITIONED AS DIRECTED ON DRAWINGS AND SUPPORTED ON APPROVED CHAIRS AND WIRED AT INTERSECTIONS.
6. TWO STRIPS OF 3-L8TM OR ONE STRIP OF 3-L11TM OR 3-N12 BARS SHALL BE PLACED DIAGONALLY ACROSS A POTENTIAL CRACK AT RE-ENTRANT CORNERS OF ALL SLABS. ALL REINFORCEMENT SHALL HAVE A MINIMUM LENGTH OF 2000
7. MESH REINFORCEMENT MUST BE UNDIMAGED FLAT SHEETS (NOT ROLLS)
8. BARS TO HAVE MINIMUM LAPS OF 40 x DIAMETER

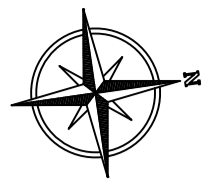

GENERAL NOTES

- ALL DIMENSIONS IN METRES U.N.O
- ALL DRAWINGS SHALL BE READ IN CONJUNCTION WITH SPECIFICATION.
- CONTRACTOR TO UNDERTAKE A DILAPIDATION SURVEY OF ALL BUILDING WITHIN 30m OF THE SITE'S BOUNDARIES PRIOR TO COMMENCEMENT OF CONSTRUCTION.
- CONTRACTOR TO MAINTAIN ACCESS TO EXISTING LOTS AT ALL TIMES DURING CONSTRUCTION.
- A DUST MANAGEMENT PLAN MUST BE SUBMITTED AND APPROVED BY COUNCIL. THE CONTRACTOR MUST ADHERE TO THE APPROVED DUST MANAGEMENT PLAN.
- REFER TO PLN_118273-E-007 FOR PAVEMENT AND KERBING DETAILS.
- REFER TO CL HYDRAULICS DRAWINGS FOR DOWNPIPE LOCATIONS.

DRAINAGE NOTES:

- THE LEVEL, ALIGNMENT, AND DIAMETER OF EXISTING DRAINAGE INFRASTRUCTURE AT PROPOSED POINTS OF CONNECTION SHALL BE CONFIRMED BY THE CONTRACTOR PRIOR TO COMMENCEMENT OF CONSTRUCTION. THE CONTRACTOR SHALL NOTIFY THE ENGINEER/SITE FOREMAN IMMEDIATELY SHOULD EXISTING DETAILS NOT MATCH THOSE SHOWN ON THE DRAWINGS.
- PIPE ALIGNMENTS SHALL BE AS SHOWN, HOWEVER THE CONTRACTOR SHALL MAKE MINOR AMENDMENTS TO ALIGNMENT TO ENSURE ADEQUATE PIPE ENTRIES INTO STORMWATER PITS WHERE NECESSARY.
- STORMWATER PITS LOCATED WITHIN THE ROAD PAVEMENT, VERGES, OR OTHER TRAFFICABLE AREAS SHALL BE CLASS D HEAVY DUTY TRAFFICABLE COVERS.
- REFER TO HYDRAULIC DRAWINGS FOR DETAILS ON DOWNPIPES AND GUTTERS.
- STORMWATER PITS COVERS SHALL BE SET TO FINISH FLUSH WITH THE FINISHED SURFACE LEVEL UNLESS NOTED OTHERWISE.
THE CONTRACTORS IS TO ASSESS IF DEWATERING IS REQUIRED PRIOR TO THE COMMENCEMENT OF ANY CONSTRUCTION WORKS. IF DEWATERING IS REQUIRED THEN THE CONTRACTOR IS TO ARRANGE AND OBTAIN A DEWATERING PERMIT PRIOR TO COMMENCING ANY DEWATERING.
- ALL WORK TO BE COMPLETED ACCORDING TO THE AS3500.1

LEGEND

- (EXISTING)
- CADASTRAL BOUNDARY
- ROAD
- NATURAL CONTOURS 0.2 INTERVALS
- DRAINAGE
- DRAINAGE MH
- SIDE ENTRY PIT
- RETAINING WALL BY OTHER
- FOOTPATH (PROPOSED)
- DESIGN CONTOURS 0.1m INTERVALS
- CATCHMENT BOUNDARIES
- EDGE OF SEAL
- RETAINING WALL BY OTHERS
- 200mm WIDE AGO S200K SLOPED CHANNEL STRIP DRAIN WITH CLASS D GRATE (REFER TO GENERAL NOTE 7)
- 0.1m HIGH IN-SITU CONCRETE "BK" (REFER TO GENERAL NOTE 6)
- 0.15m HIGH IN-SITU CONCRETE "BK1" (REFER TO GENERAL NOTE 6)
- BARRIER KERB TYPE 7 (REFER TO GENERAL NOTE 6)
- BARRIER KERB TYPE 24 (REFER TO GENERAL NOTE 6)
- PAVEMENT DRAIN (ARROW INDICATES DIRECTION OF FLOW)
- PAVEMENT DRAIN (ARROW INDICATES DIRECTION OF FLOW)
- DRAINAGE PIPE (ARROW INDICATED DIRECTION OF FLOW)
- RKO GRATED DRAINAGE PITS
- DRAINAGE PIPE TO DOWNPIPE CONNECTION (ARROW INDICATED DIRECTION OF FLOW. REFER TO PLAN FOR PIPE SIZES)
- DOWNPIPE CONNECTION (REFER TO NOTE 7)
- LANDSCAPING
- BUILDING
- CONCRETE (REFER TO NOTE 6)
- CROSSOVER TO BE CONSTRUCTED IN ACCORDANCE TO DRAWING RSD-102 (REFER TO NOTE 6)
- GRAVEL AREA (REFER TO NOTE 6)
- FOOTPATH
- WHEELSTOPS TO AS 2890.1

SERVICES AND RESTORATION:

- EXISTING SERVICES MARKED ON THIS DRAWING ARE APPROXIMATE AND ARE UNCONFIRMED.
- THE CONTRACTOR SHALL BE SOLELY AND ENTIRELY RESPONSIBLE FOR THE PROTECTION OF ALL EXISTING SERVICES AND STRUCTURES WITHIN AND ADJOINING THE SITE WHICH ARE OR MAY BE INTERFERED WITH DURING THE PROPOSED WORKS.
- THE CONTRACTOR SHALL TAKE WHATEVER MEANS NECESSARY TO DETERMINE AND CONFIRM THE LOCATIONS AND LEVEL OF ANY AND ALL UNDERGROUND SERVICES PRIOR TO COMMENCEMENT OF CONSTRUCTION IN ORDER TO DETERMINE IF CLASHES WITH THE PROPOSED WORKS WILL OCCUR. DIAL 1100.
- THE INVESTIGATION OF THE EXISTING SERVICES SHALL BE COMPLETED IN A TIMELY MANNER SUCH THAT THE PROGRAM OF THE WORKS IS NOT DELAYED SHOULD A CLASH OCCUR.
- IF THERE ARE CLASHES WITH PROPOSED SERVICES THEN THE SUPERINTENDENT SHALL BE IMMEDIATELY NOTIFIED SO THAT A COURSE OF ACTION CAN BE DETERMINED WITH THE CONTRACTOR AND THE RELEVANT SERVICE AUTHORITIES.

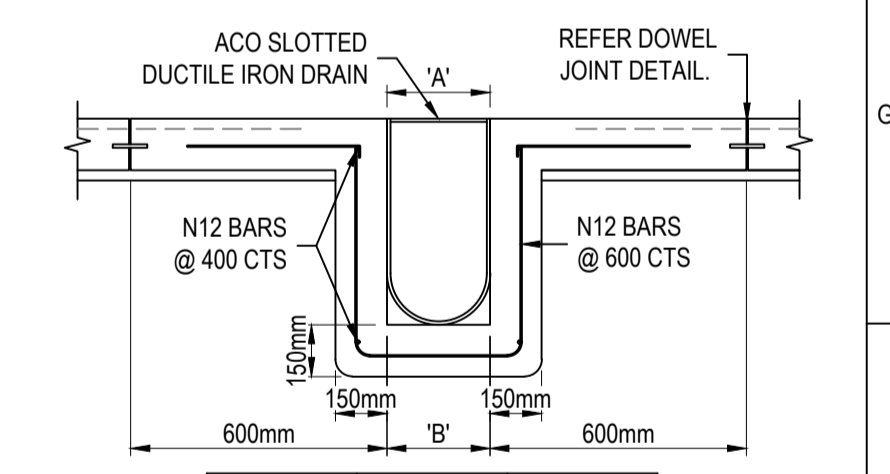

TYPE	A (mm)	B (mm)
S100K	152	460
S200K	252	560
S300K	352	660

ACO SLOTTED DUCTILE IRON
N.T.S

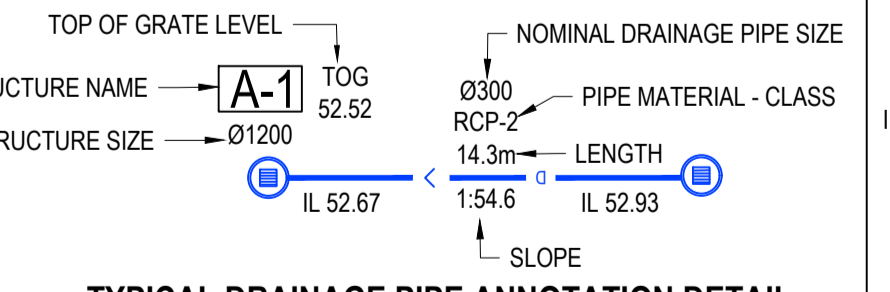

TYPICAL DRAINAGE PIPE ANNOTATION DETAIL

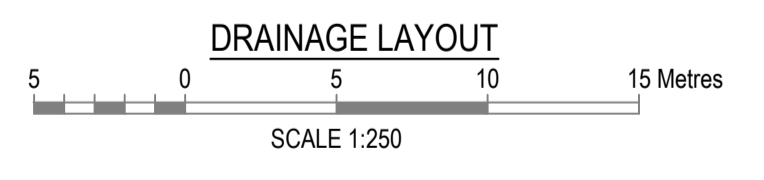
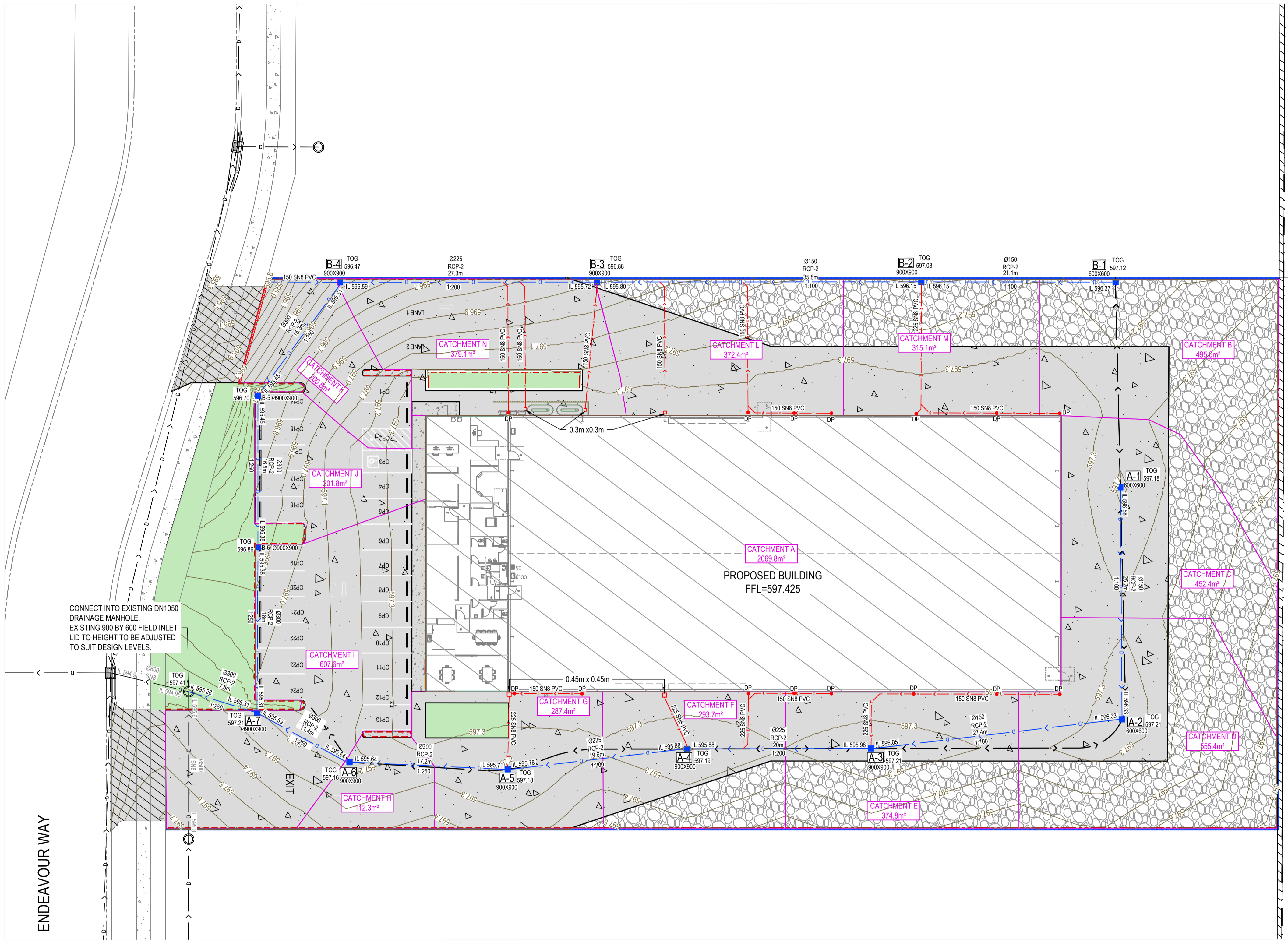

WARNING
BEWARE OF UNDERGROUND SERVICES
THE LOCATION OF UNDERGROUND CABLES ARE APPROXIMATE ONLY AND THEIR EXACT POSITION SHOULD BE CHECKED ON SITE. NO GUARANTEE IS GIVEN THAT ALL EXISTING CABLES AND SERVICES ARE SHOWN. LOCATE ALL UNDERGROUND CABLES AND SERVICES BEFORE COMMENCEMENT OF WORK. REFER TO WORKSAFE REGULATION 3.21.

REV.	BY	DATE	DESCRIPTION
A	ZS/RS	2026.04.08	FOR APPROVAL

Copyright VPE CONSULTING PLY LTD. T: +61 8 6400 7433 | Email: admin@vpeconsulting.com.au



TITLE	DRAINAGE LAYOUT
PROJECT	LOT4 ENDEAVOR WAY, TORRINGTON
DWG No.	PLN_118273-D-001

DATE	2026.04.09	REV	A
DRAWN	ZINALDU SWART		
DESIGNED	RIANDOR SWART		
CHECKED	ROBERT SMITH		
SCALE	AS NOTED ON DRAWING		
JOB REF.	PLN_118273		

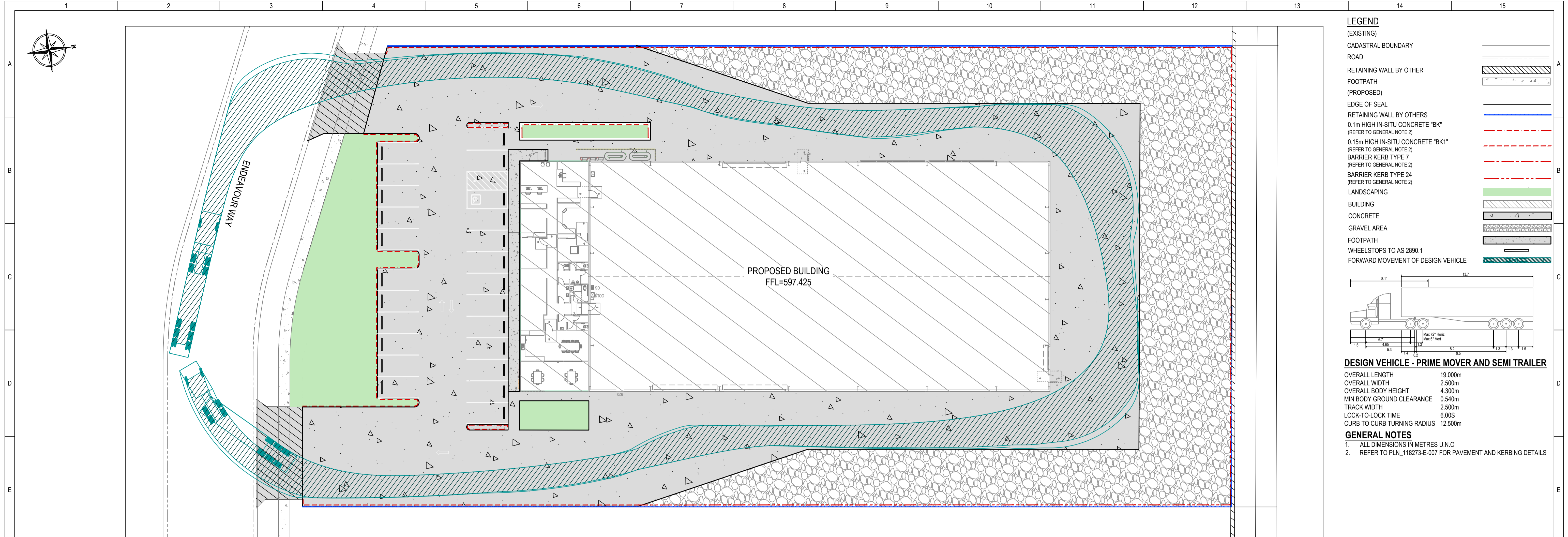

LEGEND

(EXISTING)

CADASTRAL BOUNDARY

ROAD

RETAINING WALL BY OTHER

FOOTPATH

(PROPOSED)

EDGE OF SEAL

RETAINING WALL BY OTHERS

0.1m HIGH IN-SITU CONCRETE "BK" (REFER TO GENERAL NOTE 2)

0.15m HIGH IN-SITU CONCRETE "BK1" (REFER TO GENERAL NOTE 2)

BARRIER KERB TYPE 7 (REFER TO GENERAL NOTE 2)

BARRIER KERB TYPE 24 (REFER TO GENERAL NOTE 2)

LANDSCAPING

BUILDING

CONCRETE

GRAVEL AREA

FOOTPATH

WHEELSTOPS TO AS 2890.1

FORWARD MOVEMENT OF DESIGN VEHICLE

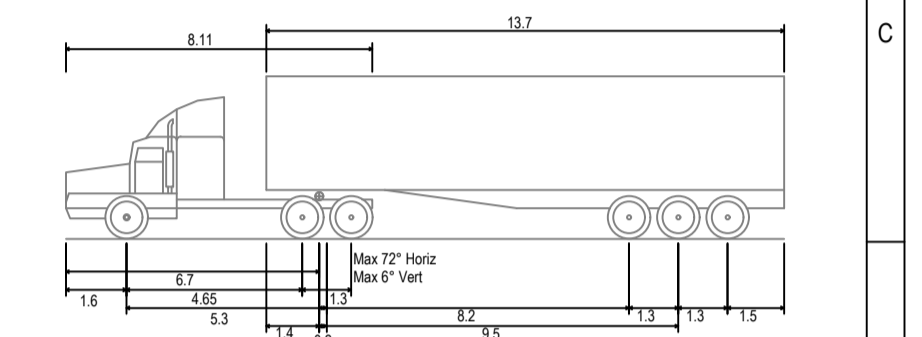

DESIGN VEHICLE - PRIME MOVER AND SEMI TRAILER

OVERALL LENGTH 19.000m

OVERALL WIDTH 2.500m

OVERALL BODY HEIGHT 4.300m

MIN BODY GROUND CLEARANCE 0.540m

TRACK WIDTH 2.500m

LOCK-TO-LOCK TIME 6.00S

CURB TO CURB TURNING RADIUS 12.500m

GENERAL NOTES

1. ALL DIMENSIONS IN METRES U.N.O

2. REFER TO PLN_118273-E-007 FOR PAVEMENT AND KERBING DETAILS

SWEPT PATHS LAYOUT

5 0 5 10 15 Metres

SCALE 1:250

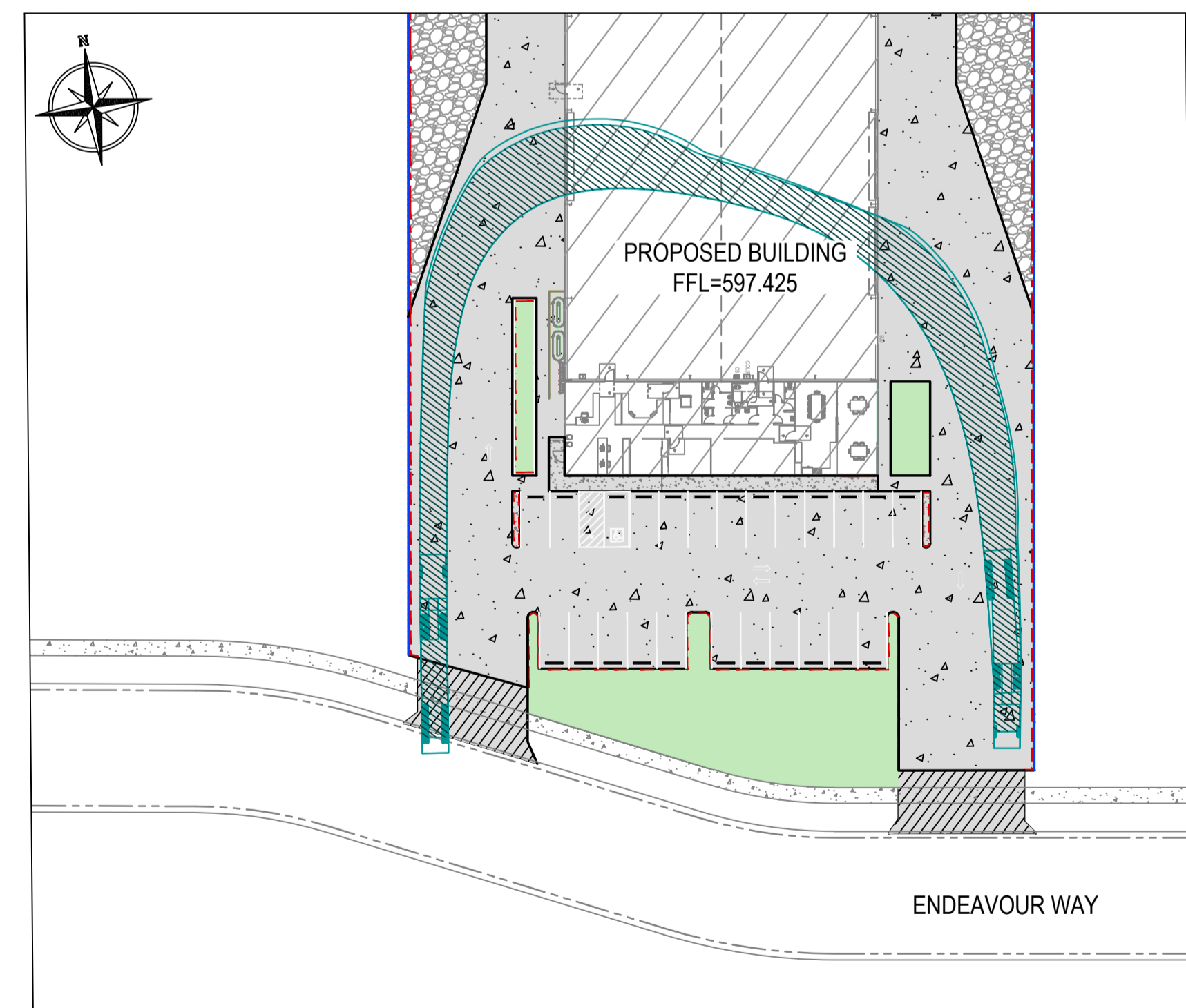

SWEPT PATHS LAYOUT - 1st ROLLER DOOR

10 0 10 20 30 Metres

SCALE 1:500

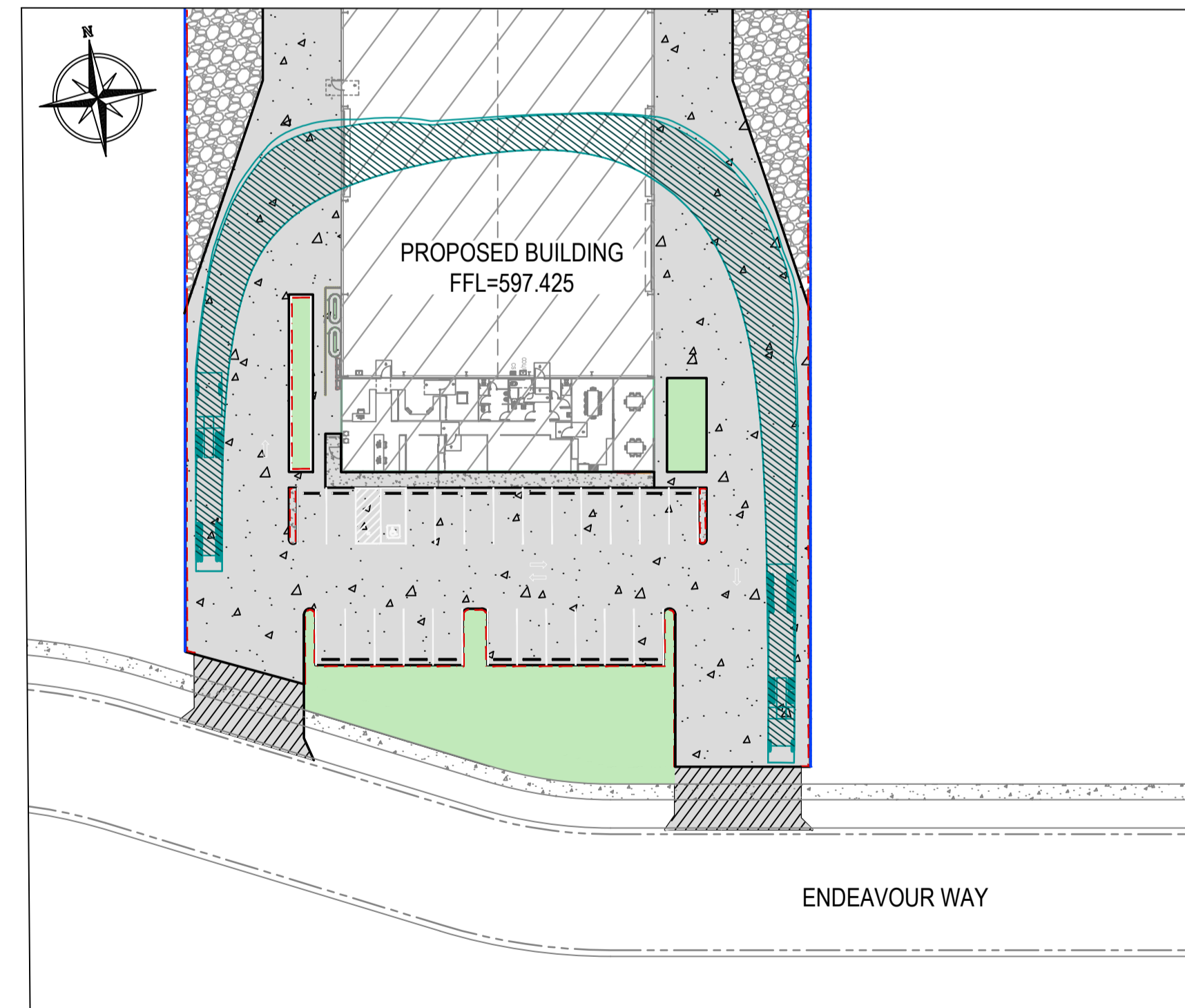

SWEPT PATHS LAYOUT - 2nd ROLLER DOOR

10 0 10 20 30 Metres

SCALE 1:500

WARNING

BEWARE OF UNDERGROUND SERVICES

THE LOCATION OF UNDERGROUND CABLES ARE APPROXIMATE ONLY AND THEIR EXACT POSITION SHOULD BE CHECKED ON SITE. NO GUARANTEE IS GIVEN THAT ALL EXISTING CABLES AND SERVICES ARE SHOWN. LOCATE ALL UNDERGROUND CABLES AND SERVICES BEFORE COMMENCEMENT OF WORK. REFER TO WORKSAFE REGULATION 3.21.

DIAL 1100
BEFORE YOU DIG

REV.	BY	DATE	DESCRIPTION
A	ZS/RS	2026.04.09	FOR APPROVAL

Copyright VPE CONSULTING PLY LTD. T: +61 8 6400 7433 | Email: admin@vpeconsulting.com.au



TITLE	DATE	2026.04.09	REV	A
SWEPT PATH LAYOUT	DRAWN	ZINALDU SWART		
PROJECT	DESIGNED	RIANDOR SWART		
	CHECKED	ROBERT SMITH		
DWG No.	A1 SCALE	AS NOTED ON DRAWING		
PLN_118273-SP-001	JOB REF.	PLN_118273		