

ROADWORKS AND ASSOCIATED SERVICES WITHIN ROBSON HURSLEY ROAD TO BE COMPLETED AS PART OF A SEPERATE OPERATIONAL WORKS APPLICATION OW/2025/3366

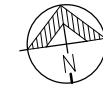

ENDEAVOUR WAY



**CONTOUR NOTE:**  
INTERVALS BETWEEN CONTOURS - 0.50m  
CONTOURS ARE DESIGN SURFACE LEVELS

**LEGEND:**

- PROPERTY BOUNDARY
- PROPOSED SEALED PAVEMENT
- ▨ LANDSCAPING
- D- PROPOSED STORMWATER PIPE
- S- PROPOSED SEWER MAIN
- W- PROPOSED WATER MAIN

- DEVELOPMENT NOTES:**
- CAR PARKS SHOWN ARE IN ACCORDANCE WITH AS2890.1:2004 USER CLASS 1 (2.4m W x 5.4 L)
  - DISABLED CAR PARKS SHOWN ARE IN ACCORDANCE WITH AS2890.6:2009 USER CLASS 4 (4.8m W x 5.4 L).
  - ROOF COLOURING TO NEW BUILDINGS TO BE NON-REFLECTIVE IN ACCORDANCE WITH THE AIRPORT ENVIRONS OVERLAY POLICY
  - PROPOSED BUILDING TO ACCOMMODATE A REFUGE BIN TO BE SERVICED REGULARLY AND AS REQUIRED.

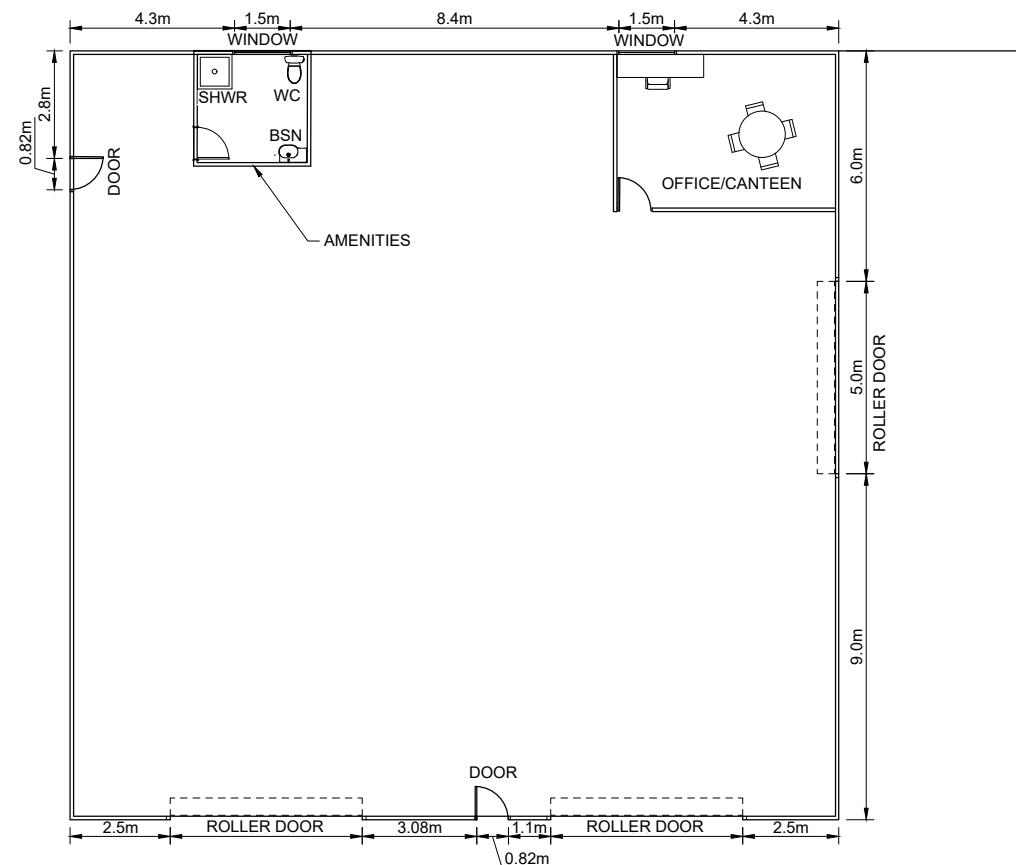
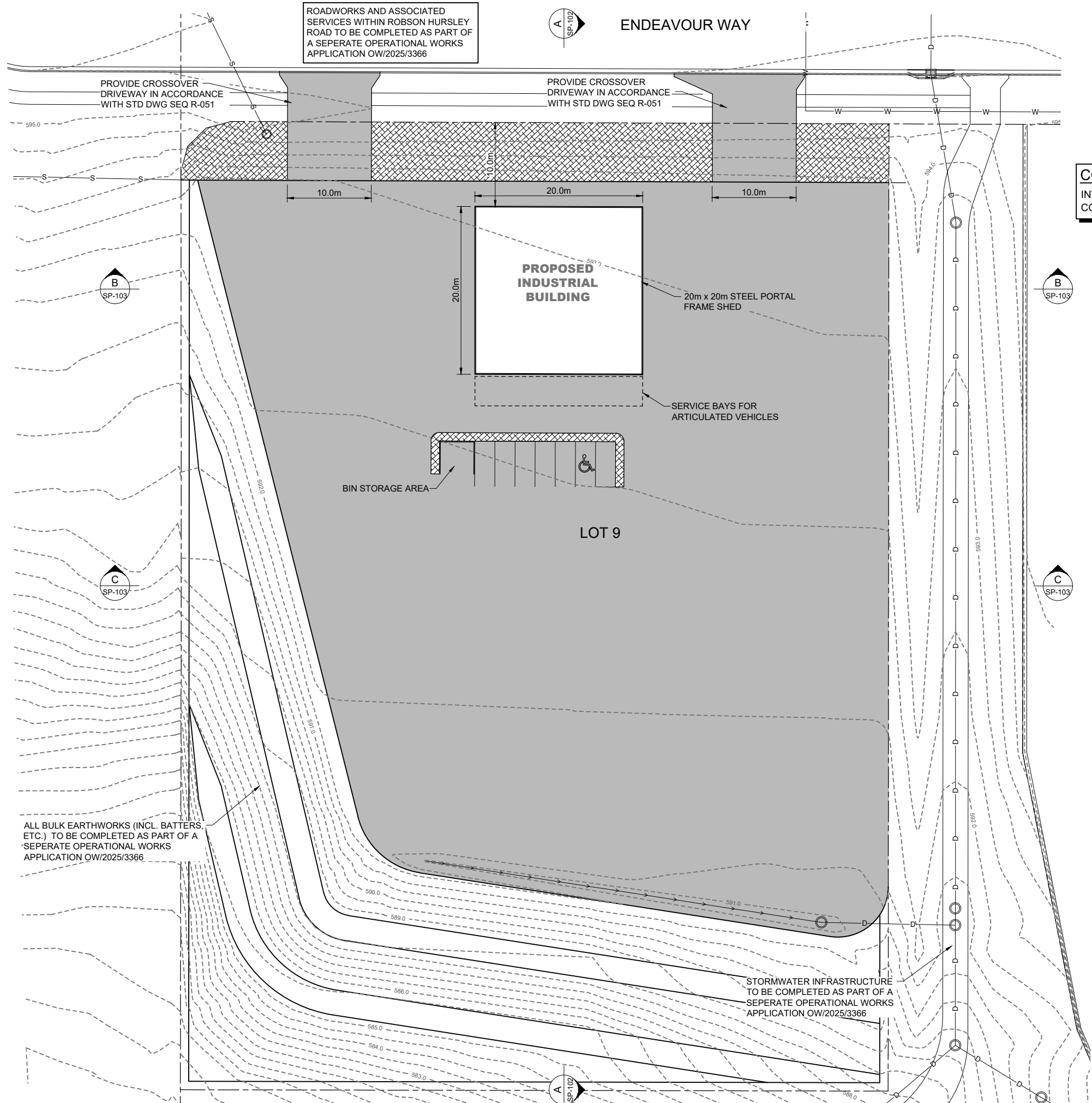

**TYPICAL BUILDING FLOOR PLAN**  
SCALE 1:100 (@A1)

**RECEIVED**  
06/05/2026  
**TOOWOOMBA REGIONAL COUNCIL**

REVISIONS	DATE	DWN	CHK	APP
B FOR APPROVAL	20/03/26	APM		
A FOR APPROVAL	20/02/25	APM		

© These drawings remain the property of AM Civil Design Pty Ltd and must not be copied in any format without the written permission of the owners of the copyright.



P: 07 4613 3364  
M: 0417 165 393  
E: andrew@amcivildesign.com.au

Client  
**TORRINGTON LAND**

Project  
**PROPOSED INDUSTRIAL DEVELOPMENT LOT 9 ROBSON HURSLEY ROAD TORRINGTON**

Title  
**PRELIMINARY SITE PLAN**

Drawn: **APM**  
Designed: **APM**

Job No. **357**  
Date **FEB'2025**  
Drawing No. **SP-101** Revision **B**