

21000 22000

360° 00' 00", 75800

3 Bed Cat 6  
150x5x1 /2 = 375m<sup>2</sup>  
Land Application Area  
Surface irrigation min 375m total  
3m radius wobblers to be used  
4 x hoses @ 2.5m  
1 Sprinkler per area required

**PROPOSED SHED**

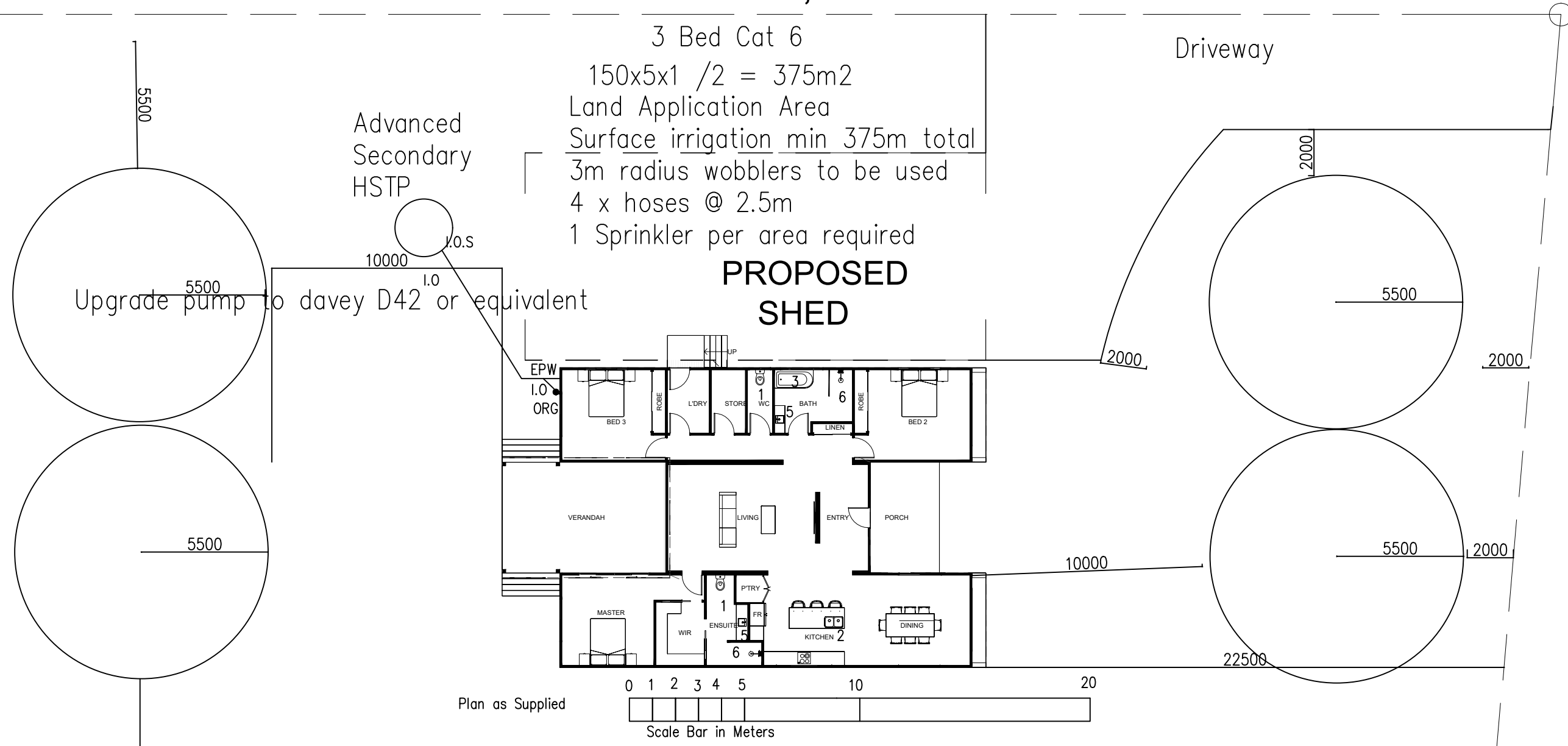

Plan as Supplied

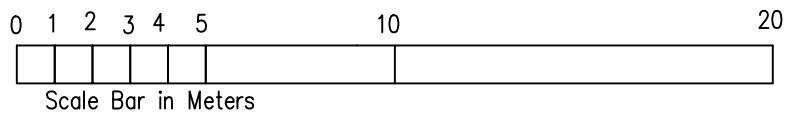

- NOS:  
1 Wc  
2 Sink Tw  
3 Bath untrapped to Fwg  
4 Tubs Tw  
5 Basins Tw to Fwg  
6 Showers Untrapped to Fwg

**NOTE:**  
1. Consult the designer before making any amendments/alterations to this design.  
2. Contour site drainage to prevent surface water entering the land application area.  
3. Where practical land application area to be exposed to prevailing winds and not shaded from sunlight.  
4. All work to be carried out by licensed persons in conjunction with the Plumbers & Drainers Act, AS 1547: The Queensland Plumbing & Wastewater Code, AS/NZS 3500 and Local Authority Conditions.  
5. Note all sewer pipes to be lagged through footings & beams using Minimum 25mm Lagging  
6. The owner is responsible for the ongoing maintenance of the HSTP and disposal areas as determined by the Department of Energy & Public Works  
7. A warning sign shall be posted at each corner of the L/A Area (or Areas)  
8. The owner shall ensure that even distribution of effluent is maintained within the nominated area and contact the service technician with any concerns, the area is not to be relocated without Council Approval.  
9. This plan is to be read in conjunction with the report as submitted and shall not be installed until Council approval is received.  
10. Ensure setback distances apply from the application area (See report tables T4, T5 & T7).  
11. Note that on some installations tank risers may be required and shall be installed to the manufacturer's details.

**A1 SEWERAGE DESIGNS**  
N.J. HOLDER CERT IV WASTE WATER MANAGEMENT  
PH: 0400 968 681 A.B.N. 15 588 441 635

CLIENT: A. & D. Bain	JOB No: 26/198	DATE: 17/06/26	SCALE: 1:200 @ A3
© Copyright A1 SEWERAGE DESIGNS		DRAWN: N.J. HOLDER	
4 Rocky Ridge Court Cotswold Hills			ISSUE 1

FLOOR PLAN - DRAINAGE PLAN

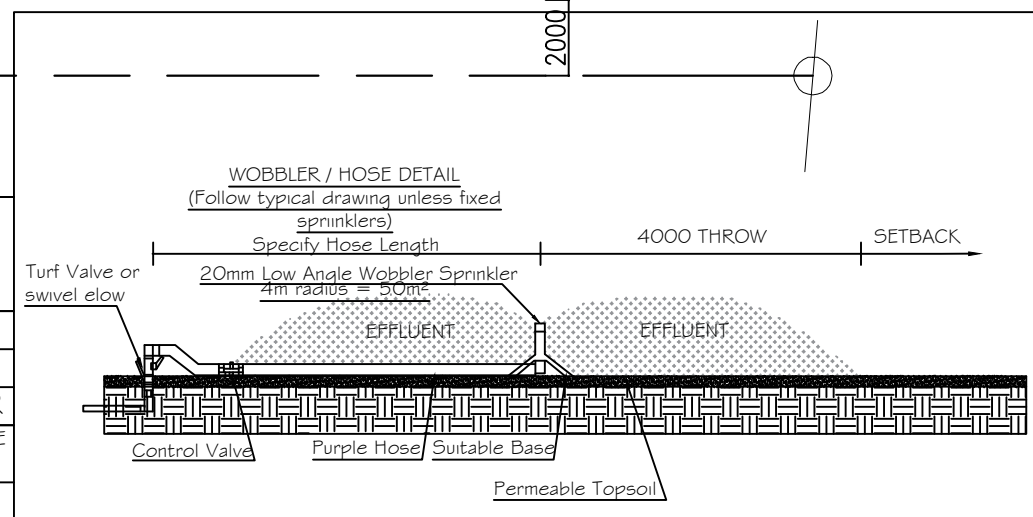

TOOWOOMBA CONNECTION ROAD

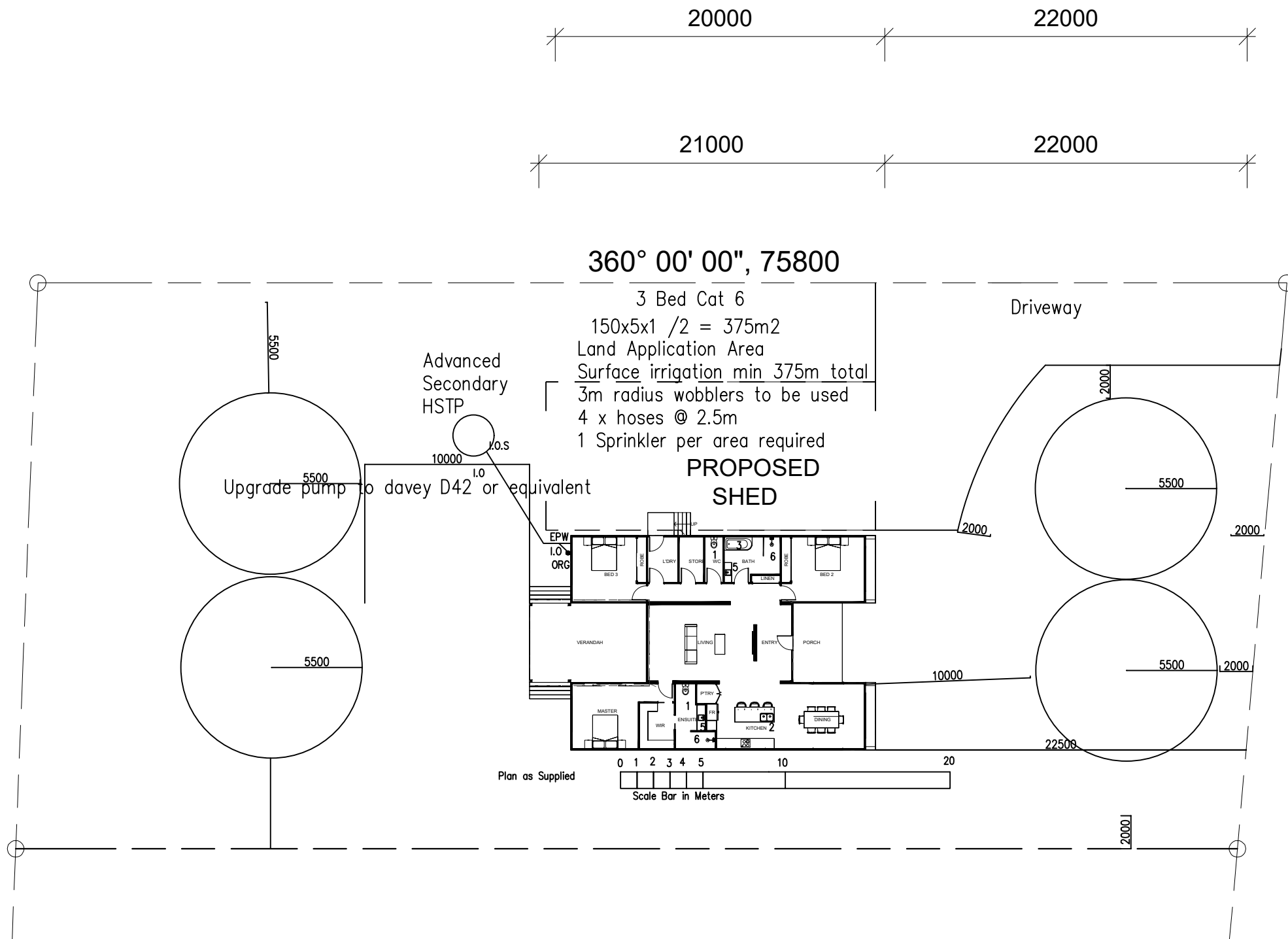

ROCKY RIDGE COURT

**NOTE:**

1. Consult the designer before making any amendments/alterations to this design.
2. Contour site drainage to prevent surface water entering the land application area.
3. Where practical land application area to be exposed to prevailing winds and not shaded from sunlight.
4. All work to be carried out by licensed persons in conjunction with the Plumbers & Drainers Act, AS 1547: The Queensland Plumbing & Wastewater Code, AS/NZS 3500 and Local Authority Conditions.
5. A warning sign shall be posted at each corner of the land application area (or areas).
6. The owner is responsible for the ongoing maintenance of the HSTP and disposal areas as determined by the Department of Energy and Public Works.
7. The owner shall ensure that even distribution of effluent is maintained within the nominated area and contact the service technician with any concerns, the area is not to be relocated without Council Approval.
8. This plan is to be read in conjunction with the report as submitted and shall not be installed until Council approval is received.
9. Ensure setback distances apply from the application area (See report tables T4, T5 & T7).
10. Note that on some installations tank risers may be required and shall be installed to the manufacturer's details
- 11 Land application areas to natural grass Grass seeded or Turfed areas .
- 12 These plans and design remain the property of A1 Sewerage until paid for in full.

**A1 SEWERAGE DESIGNS**

N.J. HOLDER      CERT IV WASTE WATER MANAGEMENT  
PH: 0400 968 681      A.B.N. 15 588 441 635

CLIENT: A. # D. Bain  
JOB No: 26/198      DATE: 17/06/26      SCALE: 1:300 @ A3  
© Copyright A1 SEWERAGE DESIGNS      DRAWN: N.J. HOLDER

4 Rocky Ridge Court Cotswold Hills

**SITE PLAN - DRAINAGE PLAN**

**CALCULATIONS:**  
AREA = QxDAYS/WEEK/DIR  
Q = LITRES/PERSON/DAY  
DAYS = 1  
DIR = 2  
(150x5x1)/2 = 750L/D (375M<sup>2</sup>)

**NOS:**  
1 Wc  
2 Utility Sink Tw  
3 Bath untrapped to Fwg  
4 Tubs Tw  
5 Basins Tw to Fwg  
6 Showers Untrapped to Fwg

⊗ SWIVEL JOINT

⊗ EXPANSION JOINT

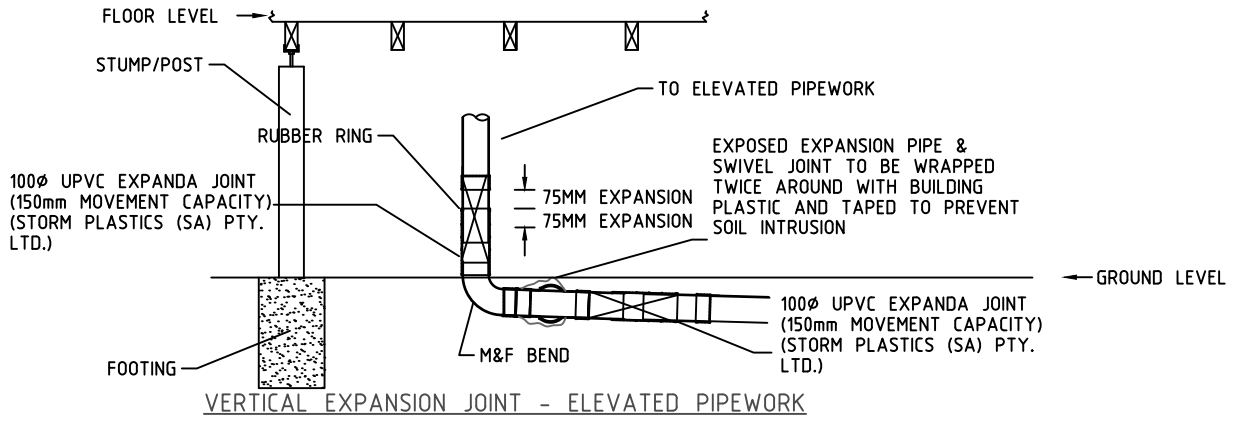

VERTICAL EXPANSION JOINT - ELEVATED PIPEWORK

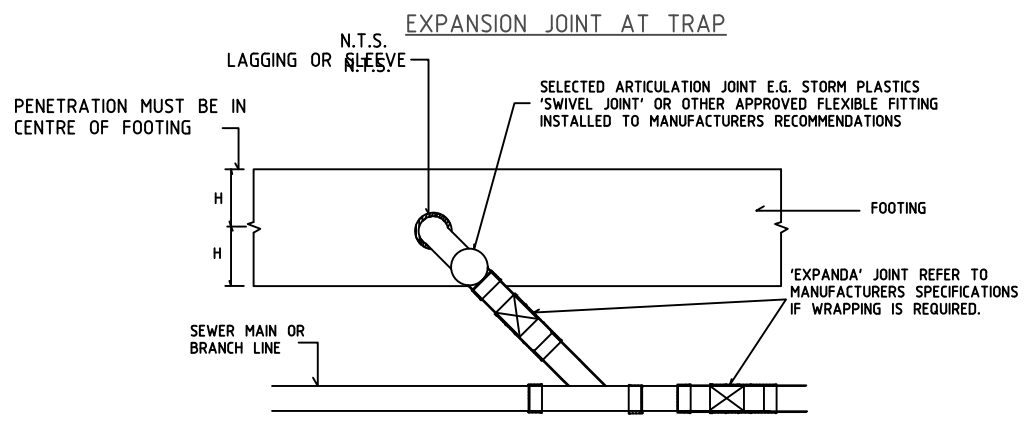

TYPICAL CONNECTION FROM PIPE WORK TO BRANCH LINE DETAIL

N.T.S.  
 EXPANSION COUPLING & SWIVEL JOINTS ONLY REQUIRED ON 'H' 'P' & 'E' SITES

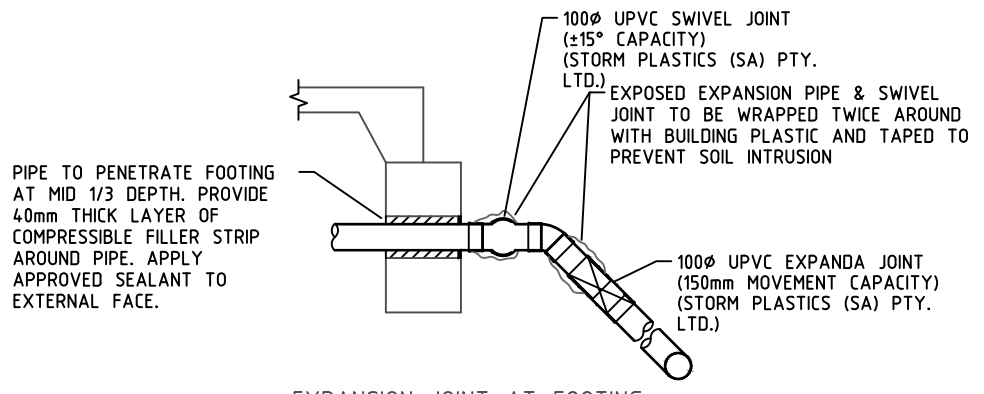

EXPANSION JOINT AT FOOTING  
 N.T.S.

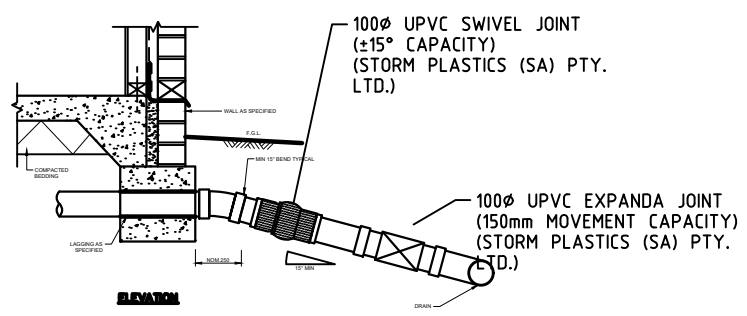

**A1 SEWERAGE DESIGNS**

N.J. HOLDER      CERT IV WASTE WATER MANAGEMENT  
 PH: 0400 968 681      A.B.N. 15 588 441 635

Title: EXPANSION CONTROL DETAILS  
 4 rocky Ridge Court Cotswold Hills  
 Soiltech as E/P

*N.J. Holder*