

IMPORTANT NOTE

This plan was prepared for J. McEvoy as a proposed subdivision to accompany a subdivision application to Toowoomba Regional Council and should not be used for any other purpose. The dimensions, areas and total number of lots shown hereon are subject to field survey and also to the requirements of Council and any other authority which may have requirements under any relevant legislation. In particular no reliance should be placed on the information on this plan for financial dealings involved in the land. This note is an integral part of this plan.



REUSHLE ROAD

CRONIN ROAD

ROAD

ADAMS ROAD

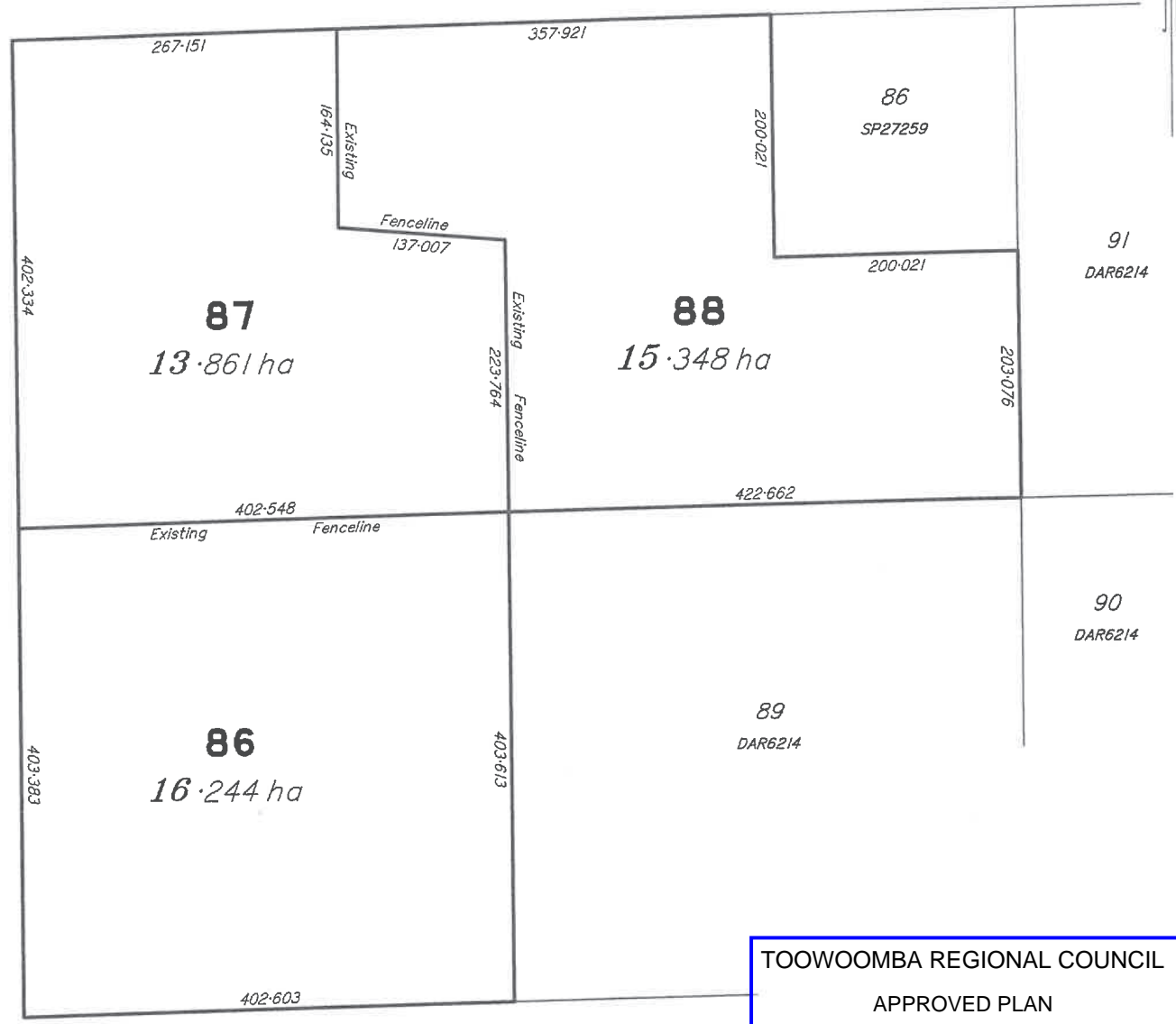

TOOWOOMBA REGIONAL COUNCIL
APPROVED PLAN
 referred to in Council's Decision Notice dated
18 June 2026
 This plan is subject to conditions of Approval Number
RAL/2025/9075

 Assessment Manager

Scale 1:4000 - Lengths are in Metres.

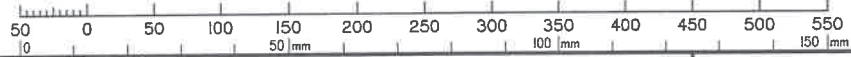

K.J. Wilson
 Cadastral Surveyor 20/10/2025

CLIENT:
J McEvoy
 CHECKED:
K. Wilson
 DRAWN:
PlanPrep

PLAN OF
Proposed Lots 86-88
 Cancelling Lot 1 on SP141761
 and Lots 2 & 88 on SP272159

K.J. Wilson
 B. Suru.
 Cadastral Surveyor 

Phone: 4639 6644 Phone: 4630 8662(A/H)
 Email: ken.jwilson@bigpond.com Mobile: 0427151725
 Email: george@kjwsurveys.com.au Mobile: 0418599339
 7 Rees Drive, Highfields, 4352
 P.O. Box 2437, Toowoomba, 4350

MAP REF: 9243-22124 SCALE: 1:4000(A3) FILE REF: K4809 VERSION: A
 © Copyright in Whole or Part - K. J. Wilson Cadastral Surveyor

LOCAL AUTHORITY: Toowoomba Regional Council LOCALITY: Cabarlah