

APPENDIX D - ENGINEERING PLANS

Kehoe Myers Consulting Engineers



NOTE:
 + ALL SHOWN SERVICES ARE FROM ON SITE VISUAL INSPECTIONS AND EXISTING RECORDS ONLY. CONTRACTOR TO CONFIRM LOCATION AND DEPTH OF ALL INGROUND SERVICES PRIOR TO ANY EXCAVATION.

COPYRIGHT
 Kehoe Myers Consulting Engineers Pty. Ltd. Reserve the right to the design and documentation of the work contained on this drawing. This work is covered by Copyright and cannot be reproduced or copied in any form without the written permission of Kehoe Myers Consulting Engineers Pty. Ltd. Any license, expressed or implied, to the use of this document is restricted to the terms of agreement between the client and consulting engineer for professional services.



DATUM
PSM
 SURVEYOR_INFORMATION

| DRAWING ISSUE | | | |
|---------------|----------|--------------|---------|
| ISSUE | DATE | DETAILS | INITIAL |
| A | 28.05.26 | FOR APPROVAL | GRP |
| | | | |
| | | | |

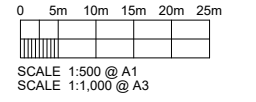

PRELIMINARY
 NOT FOR CONSTRUCTION
 DATE 28.05.26 12:31 PM

PRINT IN COLOUR

Kehoe Myers
 CONSULTING ENGINEERS KEHOEMYERS.COM.AU
 PH +617 4632 8100

CIVIL | STRUCTURAL | HYDRAULIC

CLIENT
PRECINCT URBAN PLANNING

PROJECT
**45 HIGHFIELDS ROAD,
 HIGHFIELDS - SUBDIVISION**

DRAWING TITLE
**PROPOSED ALLOTMENT
 LAYOUT**

| | | |
|----------|----------------|----------|
| DESIGN | ORIGINAL SIZE | A1 |
| DRAWN | PROJECT NUMBER | C2526370 |
| CHECKED | DRAWING NUMBER | PR01 |
| APPROVED | ISSUE | A |

NOTE:
 + ALL SHOWN SERVICES ARE FROM ON SITE VISUAL INSPECTIONS AND EXISTING RECORDS ONLY. CONTRACTOR TO CONFIRM LOCATION AND DEPTH OF ALL INGROUND SERVICES PRIOR TO ANY EXCAVATION.

| OVERALL LEGEND | |
|----------------|--|
| --- T --- | EXISTING TELECOMMUNICATION LINES |
| --- SRM --- | EXISTING SEWER RISING MAIN |
| --- W --- | EXISTING WATER MAIN |
| --- SWD --- | EXISTING STORMWATER DRAINAGE PIPE, MANHOLE AND GULLY |
| --- OH --- | EXISTING OVERHEAD ELECTRICAL LINES AND POWER POLES |
| --- WS --- | EXISTING WATER SERVICE |
| --- UG --- | EXISTING UNDERGROUND ELECTRICAL CONDUITS |
| --- W --- | PROPOSED WATER PIPE |
| --- WS --- | PROPOSED WATER SERVICE |
| --- UG --- | PROPOSED ELECTRICAL CONDUIT |
| --- > --- | PROPOSED OPEN CHANNEL AND DIRECTION |
| (A) | PROPOSED ACCESS LOCATION |
| (W) (W) | PROPOSED HOUSE WATER CONNECTIONS |
| (E) (E) | PROPOSED ELECTRICAL CONNECTIONS |

COPYRIGHT
 Kehoe Myers Consulting Engineers Pty. Ltd. Reserve the right to the design and documentation of the work contained on this drawing. This work is covered by Copyright and cannot be reproduced or copied in any form without the written permission of Kehoe Myers Consulting Engineers Pty. Ltd. Any license, expressed or implied, to the use of this document is restricted to the terms of agreement between the client and consulting engineer for professional services.

DATUM
PSM
 SURVEYOR_INFORMATION

| DRAWING ISSUE | | | |
|---------------|----------|--------------|---------|
| ISSUE | DATE | DETAILS | INITIAL |
| A | 28.05.26 | FOR APPROVAL | GRP |
| | | | |
| | | | |
| | | | |

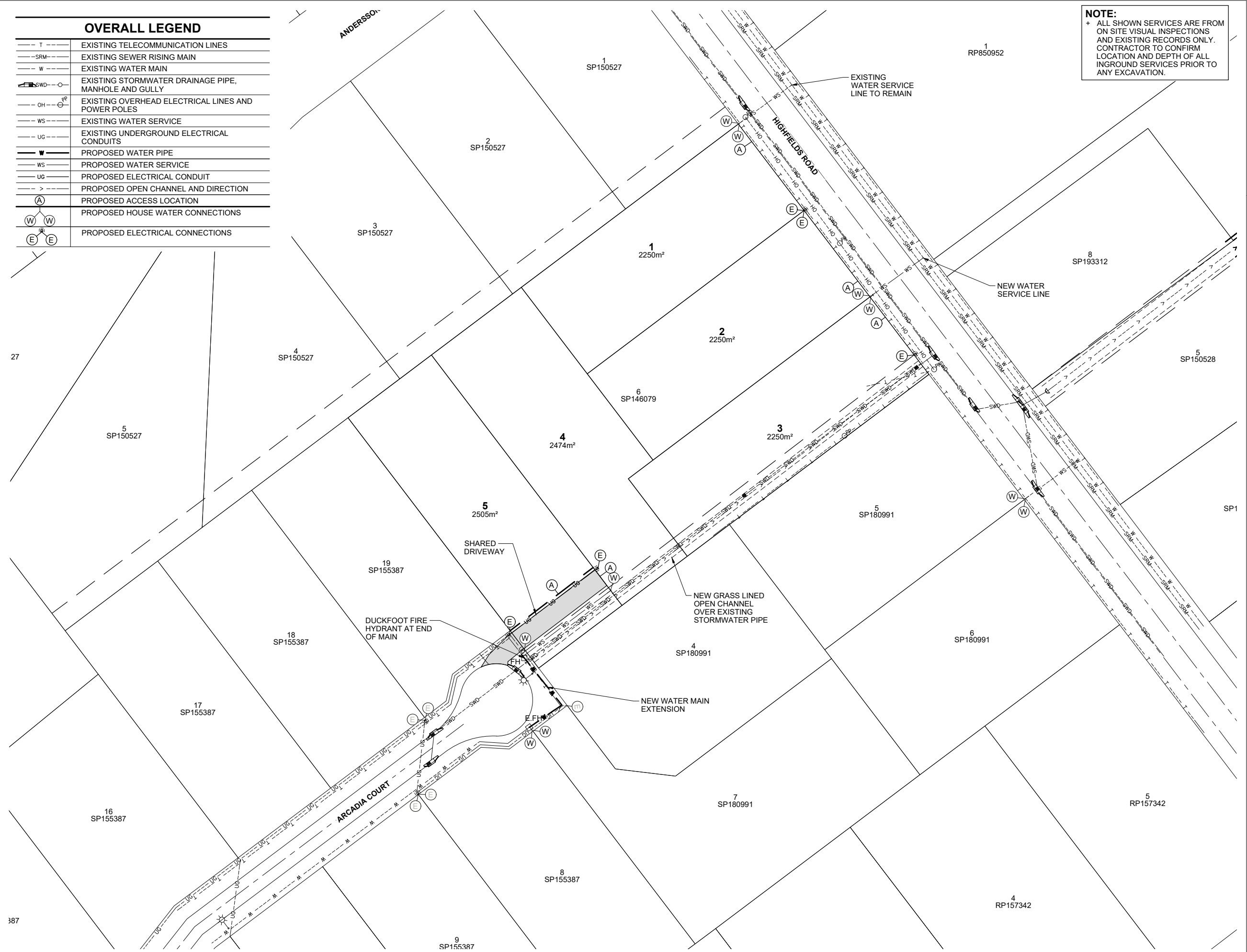
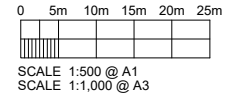

PRELIMINARY
 NOT FOR CONSTRUCTION
 DATE 28.05.26 12:21 PM

PRINT IN COLOUR

Kehoe Myers
 CONSULTING ENGINEERS KEHOEMYERS.COM.AU
 PH +617 4632 8100

CIVIL | STRUCTURAL | HYDRAULIC

CLIENT
PRECINCT URBAN PLANNING

PROJECT
**45 HIGHFIELDS ROAD,
 HIGHFIELDS - SUBDIVISION**

DRAWING TITLE
**PRELIMINARY SERVICES
 LAYOUT**

| | | |
|----------|----------------|----------|
| DESIGN | ORIGINAL SIZE | A1 |
| DRAWN | PROJECT NUMBER | C2526370 |
| CHECKED | DRAWING NUMBER | PR02 |
| APPROVED | ISSUE | A |

PRELIMINARY SERVICES LAYOUT
 SCALE:- 1:500 @ A1, 1:1000 @ A3

| DRAWING ISSUE | | | |
|---------------|----------|--------------|---------|
| ISSUE | DATE | DETAILS | INITIAL |
| A | 28.05.26 | FOR APPROVAL | GRP |
| | | | |
| | | | |

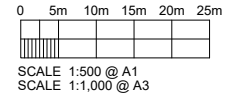

PRELIMINARY
 NOT FOR CONSTRUCTION
 DATE 28.05.26 12:22 PM

PRINT IN COLOUR

Kehoe Myers
 CONSULTING ENGINEERS KEHOEMYERS.COM.AU
 PH +617 4632 8100

CIVIL | STRUCTURAL | HYDRAULIC

CLIENT
 PRECINCT URBAN PLANNING

PROJECT
 45 HIGHFIELDS ROAD,
 HIGHFIELDS - SUBDIVISION

DRAWING TITLE
 PRELIMINARY EARTHWORKS
 LAYOUT

| | | |
|----------|----------------|----------|
| DESIGN | ORIGINAL SIZE | A1 |
| DRAWN | PROJECT NUMBER | C2526370 |
| CHECKED | DRAWING NUMBER | PR03 |
| APPROVED | ISSUE | A |

NOTE:
 + ALL SHOWN SERVICES ARE FROM ON SITE VISUAL INSPECTIONS AND EXISTING RECORDS ONLY. CONTRACTOR TO CONFIRM LOCATION AND DEPTH OF ALL INGROUND SERVICES PRIOR TO ANY EXCAVATION.



PRELIMINARY EARTHWORKS LAYOUT
 SCALE:- 1:500 @ A1, 1:1000 @ A3

NOTE:
 + ALL SHOWN SERVICES ARE FROM ON SITE VISUAL INSPECTIONS AND EXISTING RECORDS ONLY. CONTRACTOR TO CONFIRM LOCATION AND DEPTH OF ALL INGROUND SERVICES PRIOR TO ANY EXCAVATION.

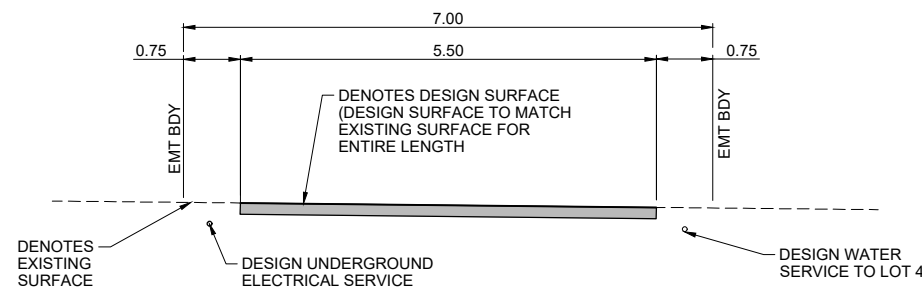

TYPICAL SECTION - SHARED DRIVEWAY (5.5m WIDE)
 SCALE:- 1:50 @ A1, 1:100 @ A3

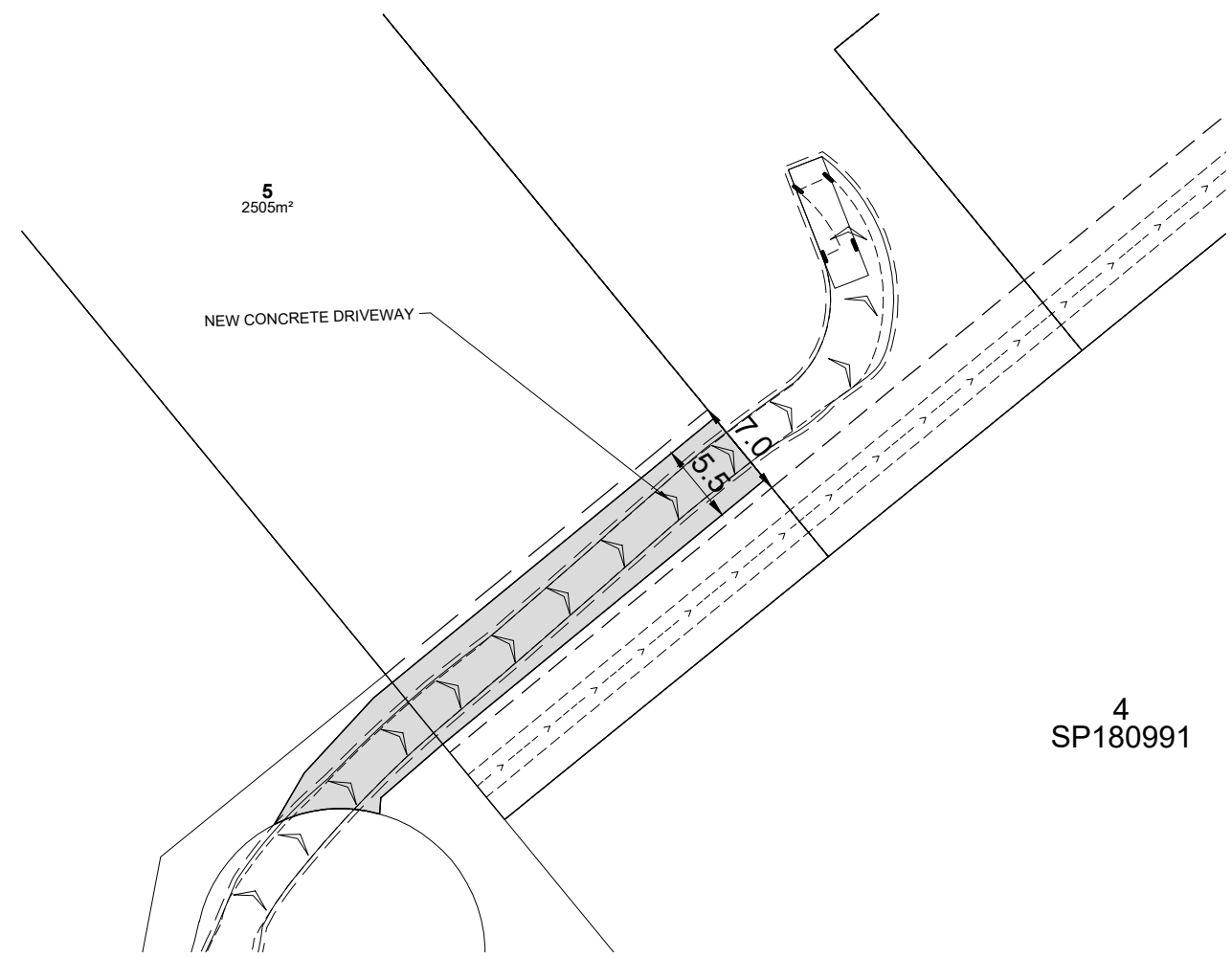
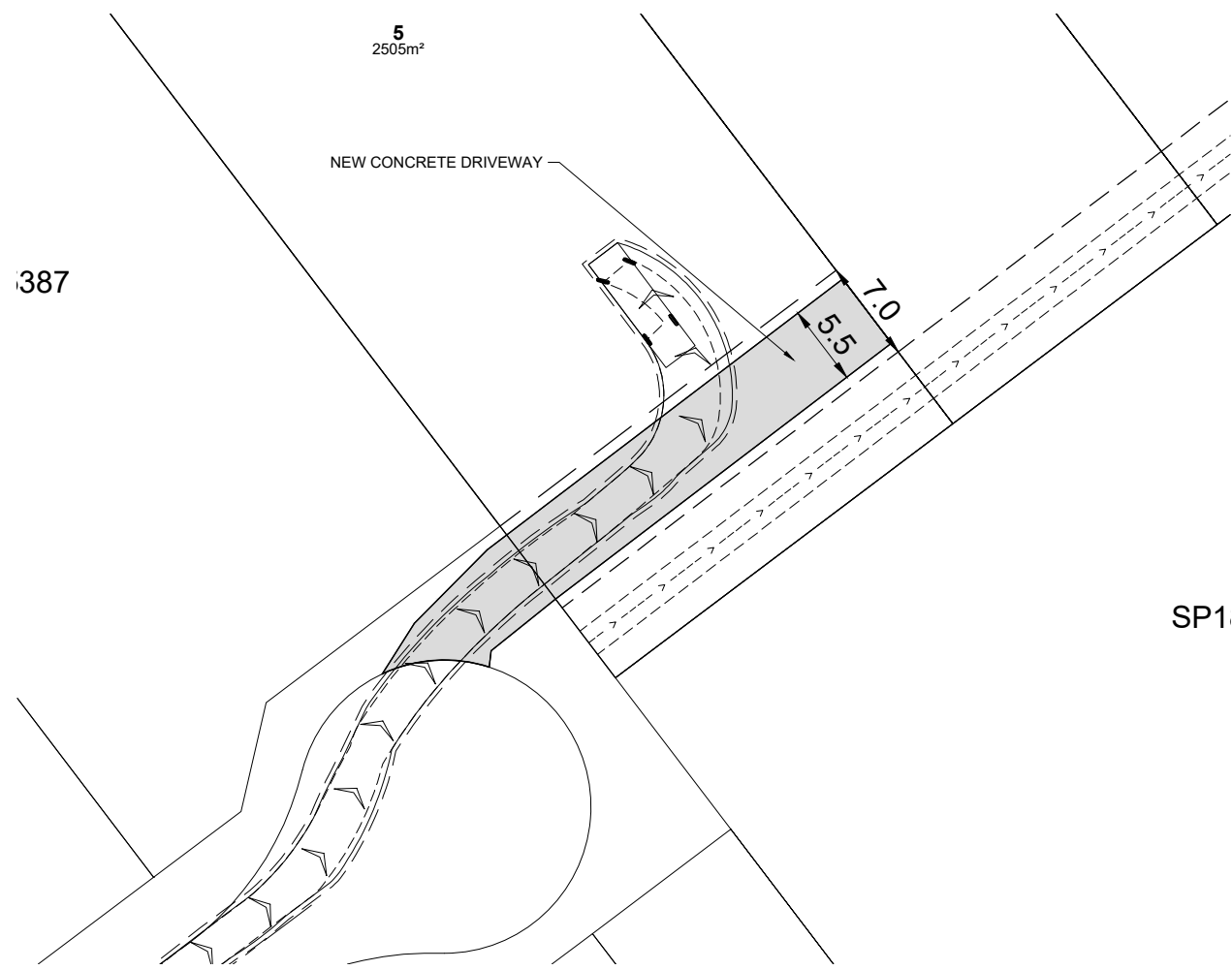
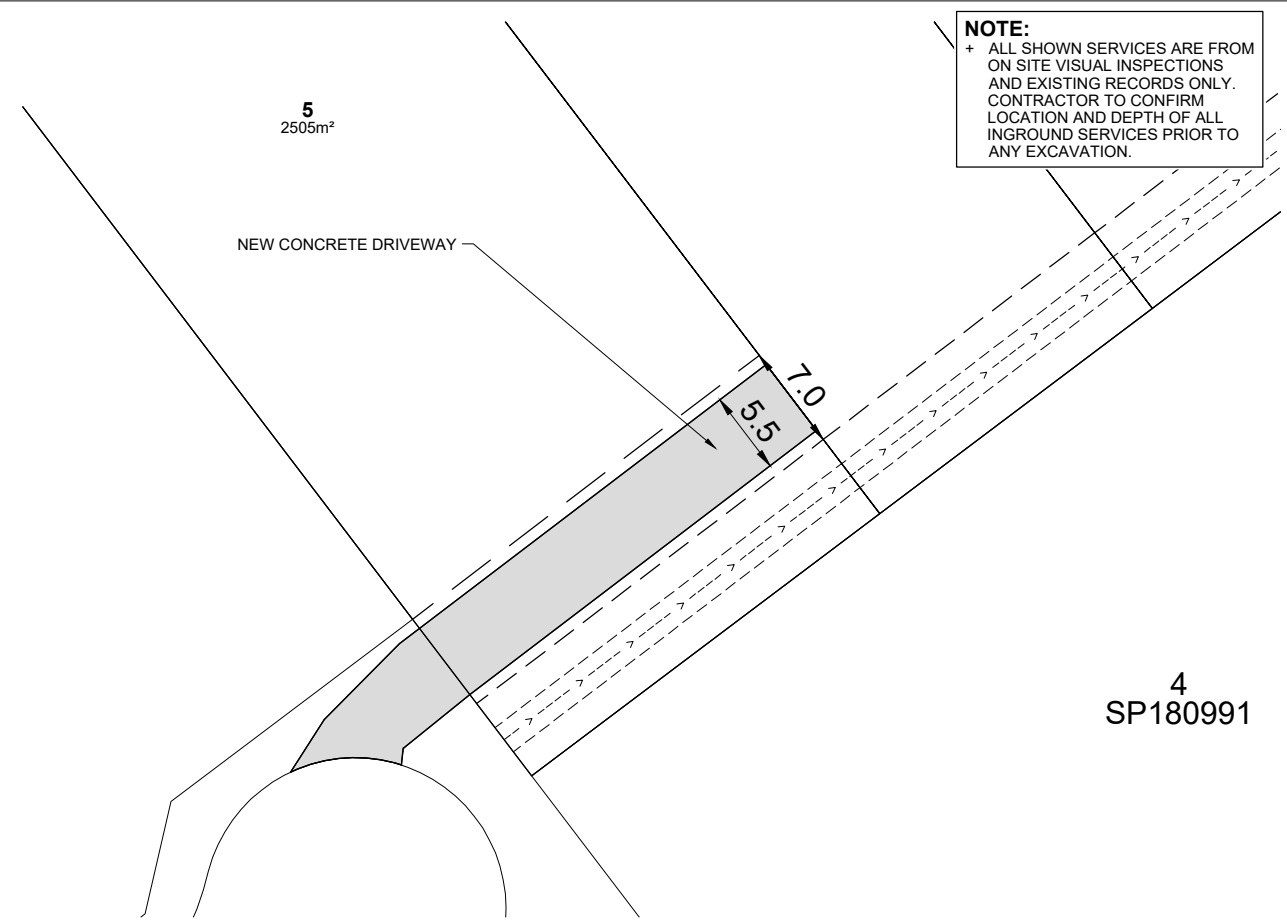

PRELIMINARY ACCESS LAYOUT
 SCALE:- 1:250 @ A1, 1:500 @ A3

COPYRIGHT
 Kehoe Myers Consulting Engineers Pty. Ltd. Reserve the right to the design and documentation of the work contained on this drawing. This work is covered by Copyright and cannot be reproduced or copied in any form without the written permission of Kehoe Myers Consulting Engineers Pty. Ltd. Any license, expressed or implied, to the use of this document is restricted to the terms of agreement between the client and consulting engineer for professional services.

DATUM
PSM
 SURVEYOR_INFORMATION

| DRAWING ISSUE | | | |
|---------------|----------|--------------|---------|
| ISSUE | DATE | DETAILS | INITIAL |
| A | 28.05.26 | FOR APPROVAL | GRP |
| | | | |
| | | | |

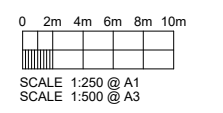

PRELIMINARY
 NOT FOR CONSTRUCTION
 DATE 28.05.26 12:36 PM

PRINT IN COLOUR

Kehoe Myers
 CONSULTING ENGINEERS KEHOEMYERS.COM.AU
 PH +617 4632 8100

CIVIL | STRUCTURAL | HYDRAULIC

CLIENT
 PRECINCT URBAN PLANNING

PROJECT
 45 HIGHFIELDS ROAD,
 HIGHFIELDS - SUBDIVISION

DRAWING TITLE
 PRELIMINARY ACCESS
 LAYOUT

| | | |
|----------|----------------|----------|
| DESIGN | ORIGINAL SIZE | A1 |
| DRAWN | PROJECT NUMBER | C2526370 |
| CHECKED | DRAWING NUMBER | PR04 |
| APPROVED | ISSUE | A |

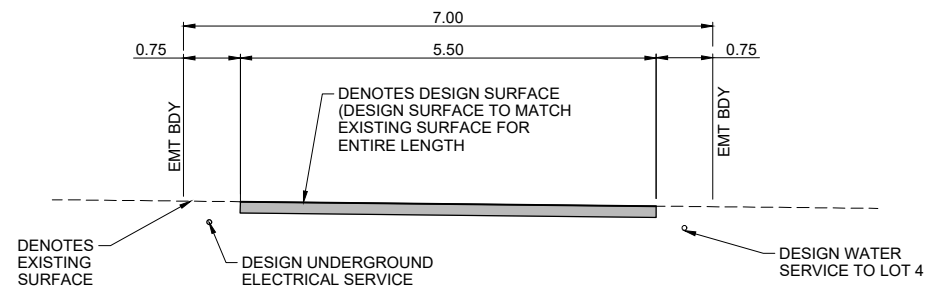

TYPICAL SECTION - SHARED DRIVEWAY (5.5m WIDE)

SCALE:- 1:50 @ A1, 1:100 @ A3

NOTE:
 + ALL SHOWN SERVICES ARE FROM ON SITE VISUAL INSPECTIONS AND EXISTING RECORDS ONLY. CONTRACTOR TO CONFIRM LOCATION AND DEPTH OF ALL INGROUND SERVICES PRIOR TO ANY EXCAVATION.

COPYRIGHT
 Kehoe Myers Consulting Engineers Pty. Ltd. Reserve the right to the design and documentation of the work contained on this drawing. This work is covered by Copyright and cannot be reproduced or copied in any form without the written permission of Kehoe Myers Consulting Engineers Pty. Ltd. Any license, expressed or implied, to the use of this document is restricted to the terms of agreement between the client and consulting engineer for professional services.

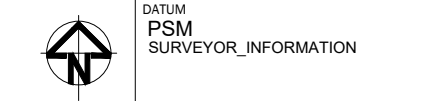

| DRAWING ISSUE | | | |
|---------------|----------|--------------|---------|
| ISSUE | DATE | DETAILS | INITIAL |
| P1 | 01.06.26 | FOR APPROVAL | GRP |
| | | | |
| | | | |
| | | | |

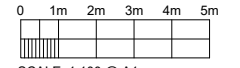

SCALE 1:100 @ A1
 SCALE 1:200 @ A3

REINFORCED CONCRETE NOTES

- MATERIALS AND CONSTRUCTION SHALL COMPLY WITH THE REQUIREMENTS OF AS3600 CONCRETE STRUCTURES.
- CONCRETE QUALITY SHALL BE:-

| ELEMENT | STRENGTH GRADE (MPa) | SLUMP (mm) | MAX. SIZE AGGREGATE (mm) | PROJECT ASSESSMENT REQUIRED |
|----------|----------------------|------------|--------------------------|-----------------------------|
| DRIVEWAY | N32 | 80 | 20 | YES |
| FOOTPATH | N32 | 80 | 20 | YES |
| KERB | N32 | 80 | 20 | YES |
| ISLAND | N32 | 80 | 20 | YES |
- CHEMICAL ADMIXTURES SHALL NOT BE USED WITHOUT THE PRIOR APPROVAL OF THE ENGINEER.
- ALL REINFORCEMENT SHALL BE AS INDICATED:-
 N - DENOTES GRADE D500N BARS TO AS/NZS 4671
 SL/RL - DENOTES WELDED WIRE MESH GRADE D500L TO AS/NZS 4671
 REINFORCEMENT IS DIAGRAMMATICALLY AND NOT NECESSARILY SHOWN IN TRUE PROJECTION.
- ALL REINFORCEMENT SHALL BE SUPPORTED IN POSITION DURING POURING BY USE OF PLASTIC TIPPED STEEL CHAIRS OR PLASTIC CHAIRS AT NOT GREATER THAN 1 METRE CENTRES BOTH WAYS. UNLESS NOTED OTHERWISE PROVIDE THE FOLLOWING CLEAR CONCRETE COVER TO REINFORCEMENT:-

| ELEMENT | COVER (mm MIN.) |
|-----------------------|-----------------|
| ALL CONCRETE ELEMENTS | 40 TOP |

- SPLICES IN REINFORCEMENT SHALL BE MADE ONLY IN POSITIONS SHOWN OR OTHERWISE APPROVED IN WRITING BY THE ENGINEER. LAPS SHALL BE MADE IN ACCORDANCE WITH AS3600 AND NOT LESS THAN THE DEVELOPMENT LENGTH FOR EACH BAR. WELDING OF REINFORCEMENT SHALL NOT BE PERMITTED UNLESS SHOWN ON THE STRUCTURAL DRAWINGS OR APPROVED BY THE ENGINEER. FABRIC SHALL BE LAPPED BY 2 TRANSVERSE BARS PLUS 50mm.
- ALL CONCRETE SHALL BE COMPACTED DURING PLACEMENT BY MECHANICAL VIBRATORS.
- NO CONCRETE IS TO BE PLACED WHEN SITE TEMPERATURE IS OUTSIDE THE RANGE OF 5°C AND 35°C.
- CONCRETE PLACED DURING ADVERSE DRYING CONDITIONS SHALL HAVE AN EVAPORATIVE RETARDANT (SUCH AS 'MBT CONFILM' OR APPROVED EQUIVALENT) APPLIED IMMEDIATELY AFTER PLACEMENT OF CONCRETE. THIS IS NOT TO BE USED AS A CURING METHOD.
- CONSTRUCTION JOINTS SHALL BE PROPERLY FORMED AND USED ONLY WHERE DETAILED OR SPECIFICALLY APPROVED BY THE ENGINEER.
- ALL CONCRETE SURFACES SHALL BE CURED BY AN APPROVED METHOD (FOR A MINIMUM OF SEVEN DAYS) IMMEDIATELY AFTER FINISHING.
- THE ENGINEER SHALL BE GIVEN 24 HOURS NOTICE FOR REINFORCEMENT INSPECTION AND CONCRETE SHALL NOT BE DELIVERED UNTIL FINAL APPROVAL IS GIVEN.

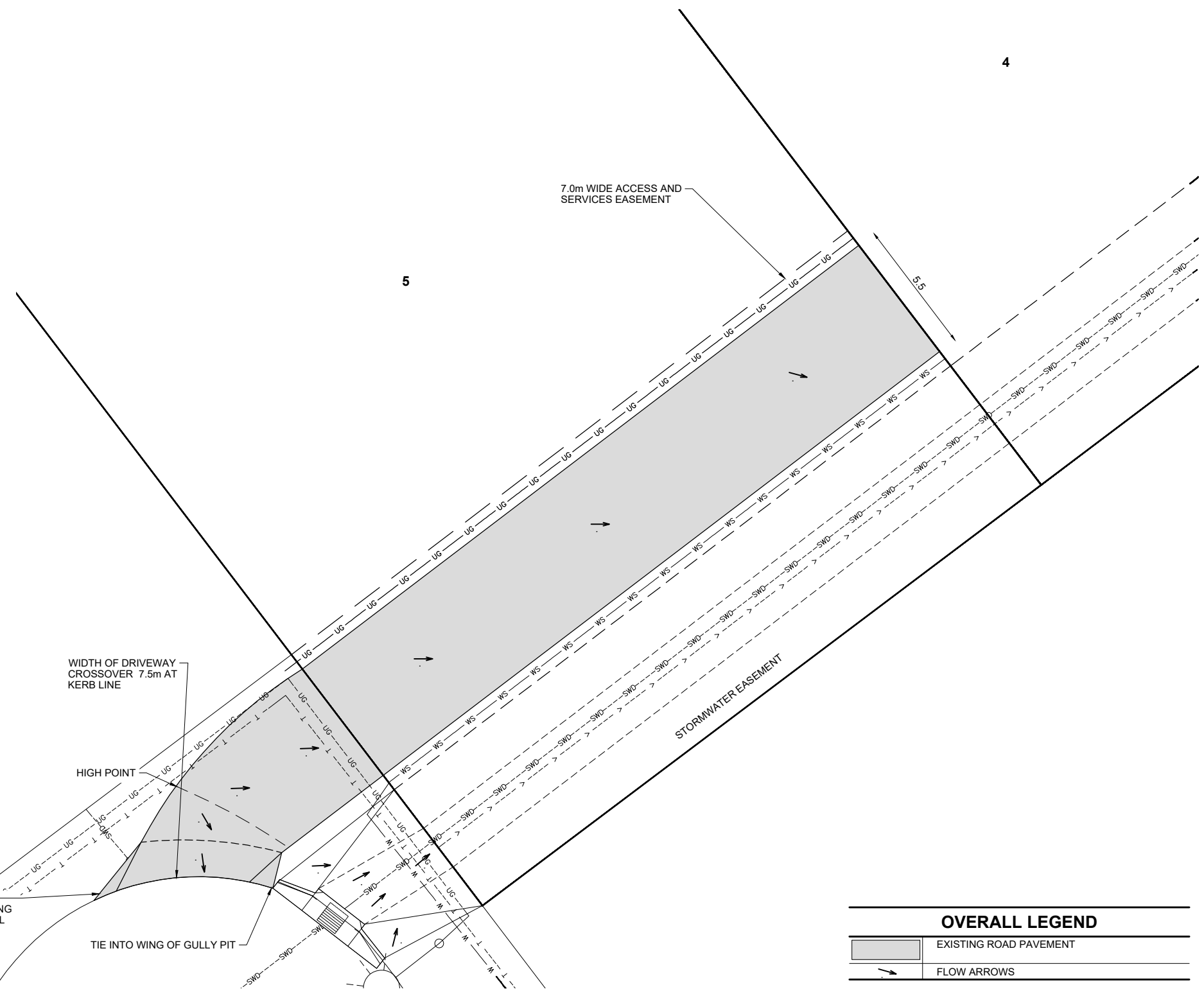

| OVERALL LEGEND | |
|----------------|------------------------|
| | EXISTING ROAD PAVEMENT |
| | FLOW ARROWS |

PRELIMINARY ACCESS LAYOUT
 SCALE:- 1:100 @ A1, 1:200 @ A3

PRELIMINARY
 NOT FOR CONSTRUCTION
 DATE 01.06.26 03:47 PM

PRINT IN COLOUR

CIVIL | STRUCTURAL | HYDRAULIC

CLIENT
 PRECINCT URBAN PLANNING

PROJECT
 45 HIGHFIELDS ROAD,
 HIGHFIELDS - SUBDIVISION

DRAWING TITLE
 PRELIMINARY ACCESS PLAN

| | | | |
|----------|-----|----------------|----------|
| DESIGN | GRP | ORIGINAL SIZE | A1 |
| DRAWN | TB | PROJECT NUMBER | C2526370 |
| CHECKED | GRP | DRAWING NUMBER | PR06 |
| APPROVED | | ISSUE | P1 |